

ISO 9001:2015

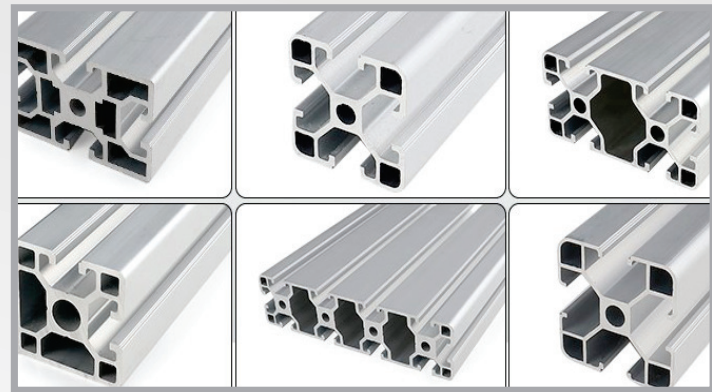
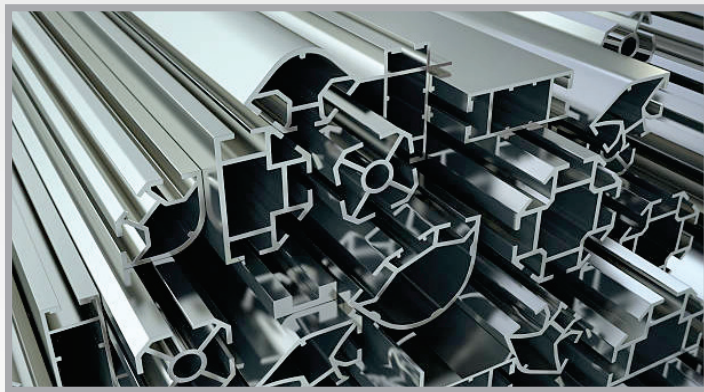
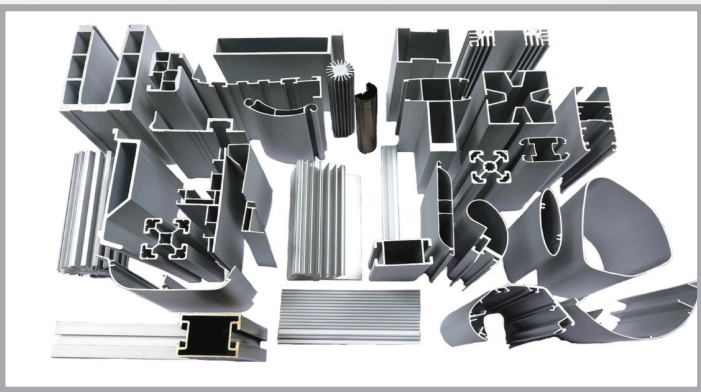

APAR ALUMINIUM EXTRUSION

📍 Survey No. 760p3, Near Indane Gas Depo, Village: Bagathala, Bagathala-Kantipur Road, Tal: Morbi, Dist: Morbi, Gujarat, India-363641.

✉ E-mail Id: aparaluminiumextrusion4284@gmail.com

☎ +91 75676 62128

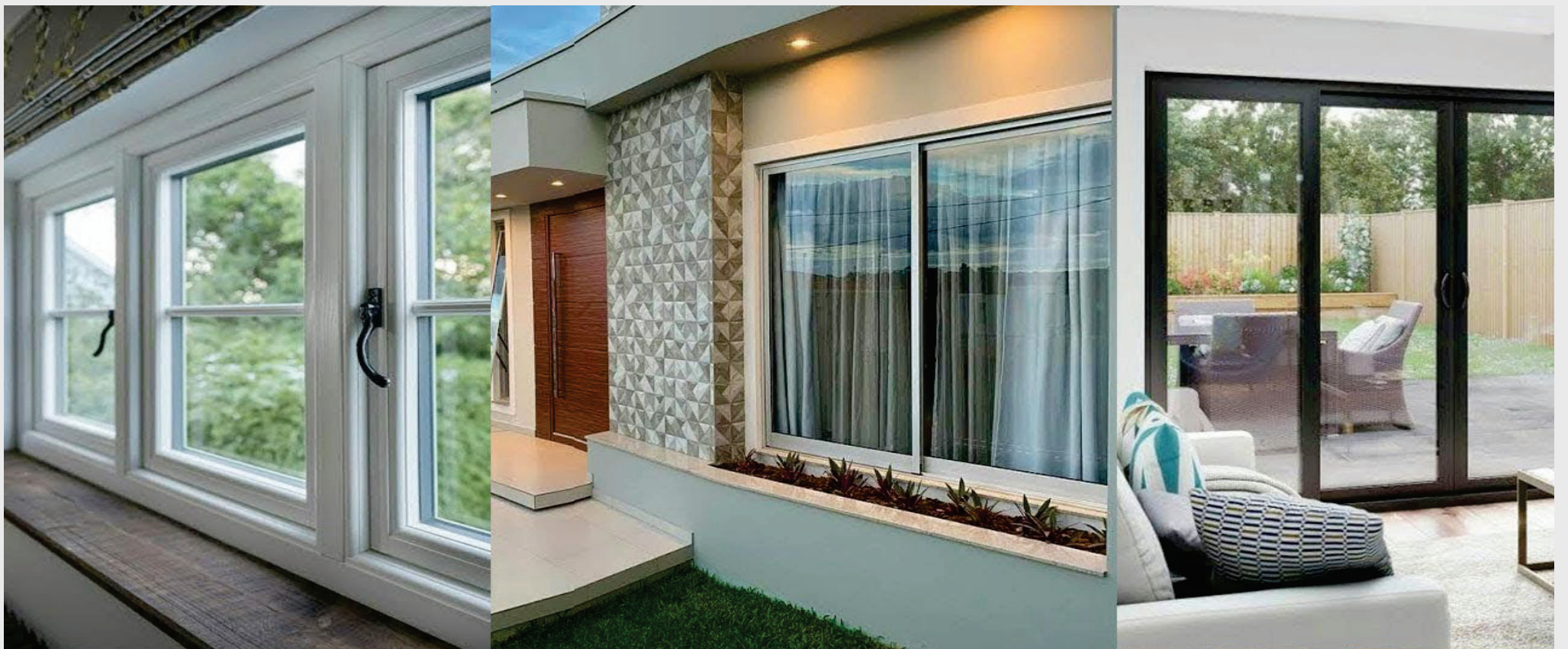



ABOUT US...

Apar Alluminum (India) Pvt Ltd with an impressive portfolio of Manufacturing, Marketing, & Exports is imminent challenger in the field of Alluminum Extrusion.

The Company is privately owned and employs a team of highly experienced, qualified engineers, production personnel and office staff. It is our experience, flexibility and renowned attention to detail that give us our unique market position.

The Company will operate the guideline of ISO 9001:2022 for both products and systems allowing us to gain the relevant approvals for existing products and providing a platform for entry into new market.

It is from our factory and Headquarters in Morbi, Gujarat that the complete specification and subsequent design is put together by our team headed by eminent Entrepreneurs

Director manager Sunil Patel Mo. +91 75676 62128 ,

Director manager Bharat Patel Mo. +91 99256 29273

APAR with high end Taiwanese technology is formed to service a more specialist market. The strength lies in the development and production of quality specialist Industrial, Architectural, Electrical and Transport.

Company has set up plant of 300 Ton production capacity Per Month. The agreed product is manufactured to strict quality procedures and fine tuned to suit the industrial requirement.

Customer Satisfaction is the top most priority at APAR ALLUMINUM (INDIA) PVT LTD. We reach our customer through our well developed, trained marketing team and network of dealers and distributors all over India. We understand our customer need and give out best to satisfy the customer. Our clients vary from private sector to Government Sector to Export Market.

APAR is very well established in the areas of their activity and is adored by its customer in terms of commitment. The quality of product is unmatched and appeals to all the needful.



VISION, QUALITY AND ASSURANCE

At APAR, we firmly believe that the success of business depends on providing high quality products and services to all valued customers through efforts of its team members.

Quality Management is practiced from the top management to the lower most position in the product realization process. Quality is ensured at every stage right from the input material to the finished product. The four stages of quality assurance areas below:

Pre Production Quality Assurance

All received raw material are inspected thoroughly before issuing to production. Each raw material cross strict 'Quality Control' specifying quality standard.

In Process Control

Each process of production, quality is ensured by rigorous checking process. All standard parameters of quality standard and norms.

Post Production Quality Assurance

Before sending the production to stockyard, final inspection is always done to verify that product has crossed all the parameters of quality standard and norms.

Always proper batch coding is given to the production, shift wise and day wise by video jet printing on one side of extrusion which gives a complete data information of all inputs of raw materials used during production.

Dispatch Quality Assurance

To take the extra mileages of customer satisfaction, confidence, Dispatch Department always ensure that best of material to be received by our customer.

QUALITY MISSION STATEMENT

APAR is committed to focusing on supplying our customers with highly reliable, cost effective quality products and services.

In order to achieve the highest possible quality standards in our industry we will strive to advocate the following quality values; Provide dynamic leadership in a work environment that encourages employee involvement. Partnered with our suppliers to develop quality products that will meet our customer's expectations.

Promote systems and processes that will cause quality and help us become the most efficient producer in our industry.

Produce a quality product in a safe environment using the latest in manufacturing technology while ensuring industry leading service and support.

Deal honestly and fairly with our customers, suppliers, employees, and government.

Quality Initiatives in striving to eliminate production defects, APAR has developed a comprehensive Quality Control System.

This program includes: In-line inspection of production process.

- Final pre-shipment inspection** of completed product.
- Continuous random sample product testing**-product pulled from the line for air and water testing at our in house test chamber.
- Employee involvement and accountability through sign off on individual work and feedback from quality inspections and sample testing.**
- Ongoing in house structural, air and water testing, as well as external certification testing of existing and new product lines.**
- Comprehensive reporting and tracking of deficiencies and the consequent corrective actions.**
- Closed quality loop**- reporting and documentation facilitates root cause identification allowing process and design adjustments to be made with our full time Quality Technical Support and Design team.
- Production supervisor feedback and involvement by means of weekly quality update meetings.**

1. Manufactured from high quality billets made from in-house virgin metal.
2. Better control on impurities and superior finish lead to excellent anodizing.
3. Well-established manufacturing process and heat treatment practices honed over 5 decades of experience.
4. Traceability of material rightfrom metal stage.
5. Comprehensive testing facility.
6. Available in wide range of shapes and sizes.
7. Excellent corrosion resistant.
8. Tightest DimensionalTolerance improves quality of fabrication and minimizes rejection.
9. Suitable for wide range of finishes to match the decors. Anodized. Powder coated, Polyvinylidene Fluoride (PVDF) coated, wood coated etc.

Major Application

1. Windows (Sliding & Casement)
2. Doors
3. Partitions/Shop Fronts
(Tower Bolts/Aldrops/Hinges Door Handles)
4. Hardwares
5. Curtain Wallings/Structural Glazing
6. FalseCeiling
7. Northing Glazing
8. Ladders
9. Furniture/Modular System
10. Hand Railing
11. Wall facing
12. Expanded Grills
13. Venetian Blind & Curtain Rails
14. Aluminum Form Work
- 15 Mosquito Net
16. Louvers& Sun Screen
17. Rolling Shutters



INDEX

SECTION NO.	PAGE NO.	SECTION NO.	PAGE NO.
01 - 02	01	089 - 091	16
03 -07	02	092 - 095	17
008 - 018	03	096 - 098	18
019 - 034	04	099 - 104	19
035 - 043	05	105 - 109	20
044 - 049	06	110 - 114	21
50 - 51	07	115 - 120	22
052 - 057	08	121 - 124	23
058 - 061	09	125 - 131	24
062 - 065	10	134 - 139	25
066 - 068	11	140 - 143	26
069 - 075	12		27
076 - 079	13		28
080 - 083	14		29
084 - 088	15		30

3/4" TWO TRACK TOP

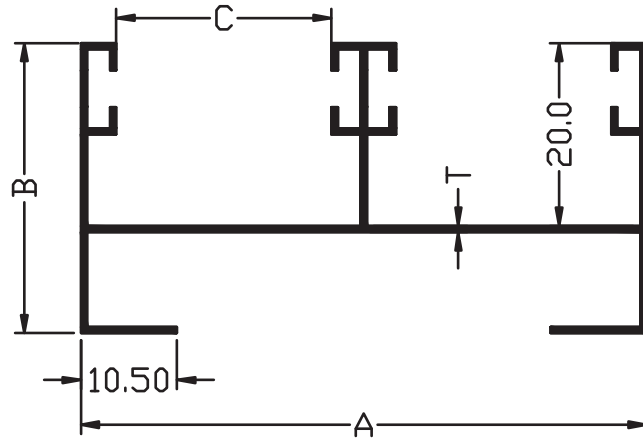

SEC. NO.	C/L	A	B	C	T	WEIGHT
001	12	61.85	31.75	23.50	0.68	1.350-1.550

3/4" TWO TRACK BOTTOM

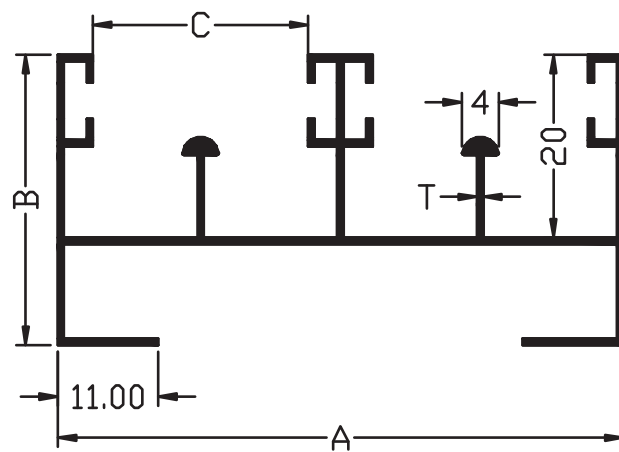

SEC. NO.	C/L	A	B	C	T	WEIGHT
002	12	61.85	31.75	23.50	0.68	1.600-1.800

60X18 INTERLOCK

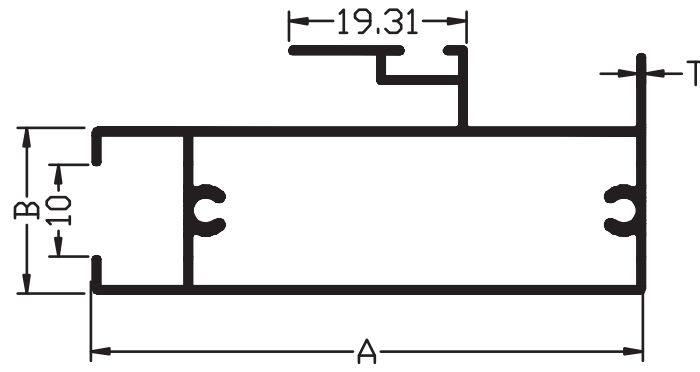

SEC. NO.	C/L	A	B	T	WEIGHT
003	12	60.00	18.00	1.10	1.900-2.100
004	12	60.00	18.00	1.50	2.600-2.900

60X18 HANDLE

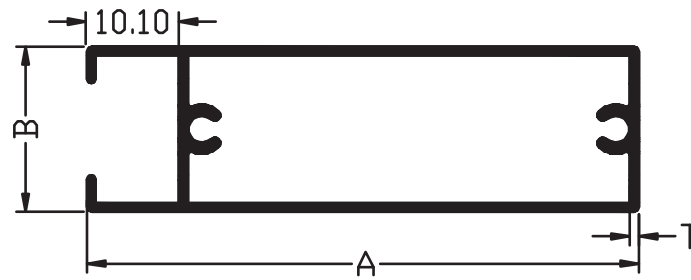

SEC. NO.	C/L	A	B	T	WEIGHT
005	12	60.00	18.00	1.50	2.400-2.700

60X18 TOP BOTTOM

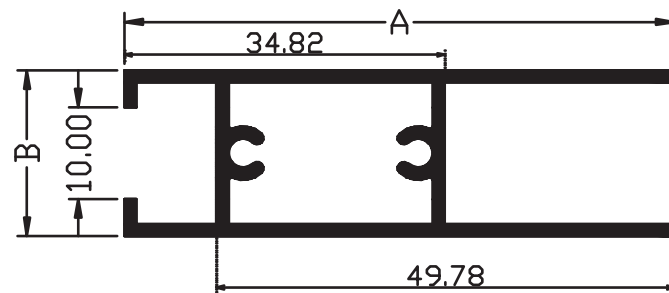

SEC. NO.	C/L	A	B	T	WEIGHT
006	12	60.00	18.00	1.10	1.900-2.100
007	12	60.00	18.00	1.50	2.600-2.900

3/4" THREE TRACK BOTTOM

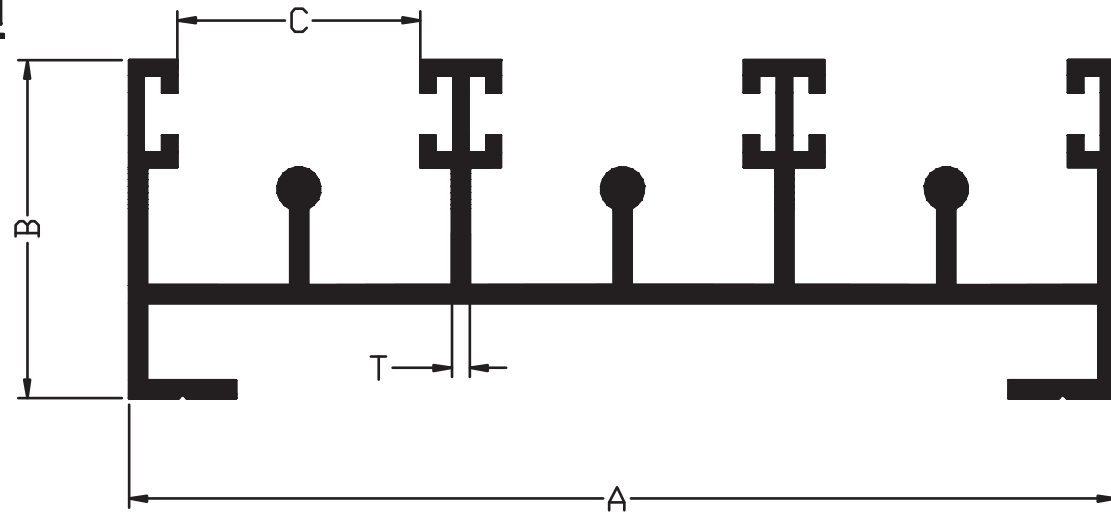

SEC. NO.	C/L	A	B	C	T	WEIGHT
008	12	92.00	31.5	23.9	0.77	2.200-2.500
009	12	92.00	31.5	23.9	0.89	2.800-3.000
010	12	92.00	31.5	23.9	1.10	3.200-3.400
011	12	92.00	31.5	23.9	1.30	3.900-4.100
012	12	92.00	31.5	23.9	1.50	4.500-4.700

3/4" THREE TRACK TOP

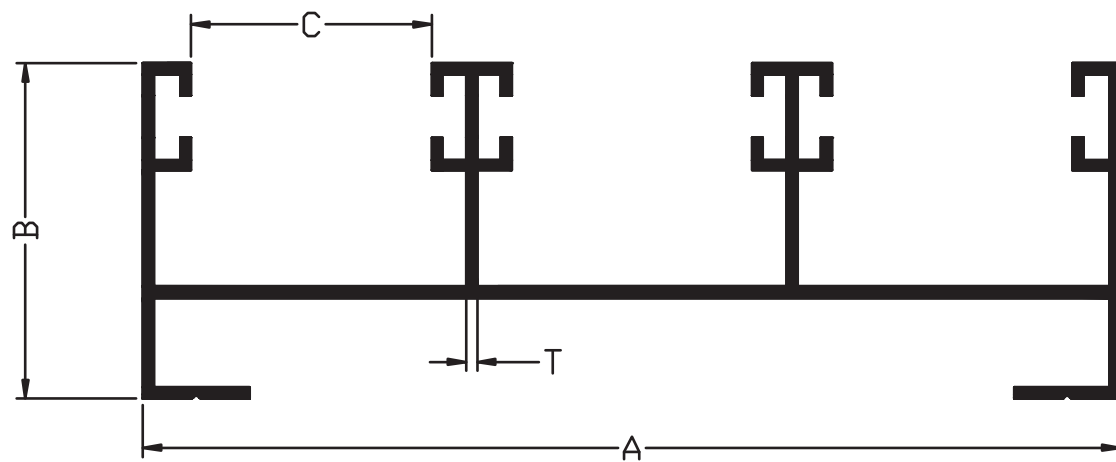

SEC. NO.	C/L	A	B	C	T	WEIGHT
013	12	92.00	31.5	23.9	0.65	1.800-2.000
014	12	92.00	31.5	23.9	0.72	2.000-2.200
015	12	92.00	31.5	23.9	0.87	2.400-2.600
016	12	92.00	31.5	23.9	0.98	2.700-3.000
017	12	92.00	31.5	23.9	1.30	3.400-3.600
018	12	92.00	31.5	23.9	1.50	3.700-3.900

3/4" HANDLE

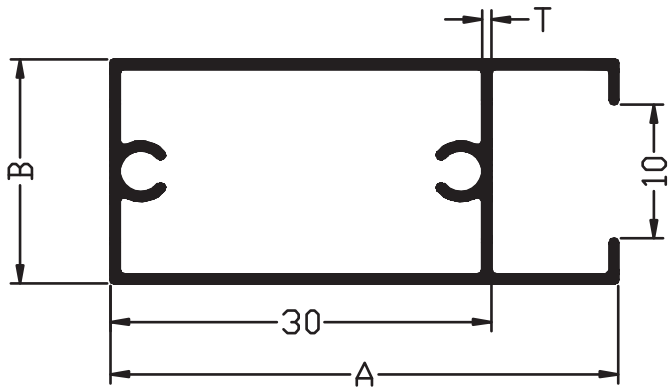

SEC. NO.	C/L	A	B	T	WEIGHT
19	12	40.00	18.00	0.68	0.900-1.000
20	12	40.00	18.00	0.75	1.000-1.200
21	12	40.00	18.00	0.90	1.200-1.400
22	12	40.00	18.00	1.05	1.400-1.600
23	12	40.00	18.00	1.22	1.600-1.700
24	12	40.00	18.00	1.50	1.800-2.000

3/4" INTERLOCK

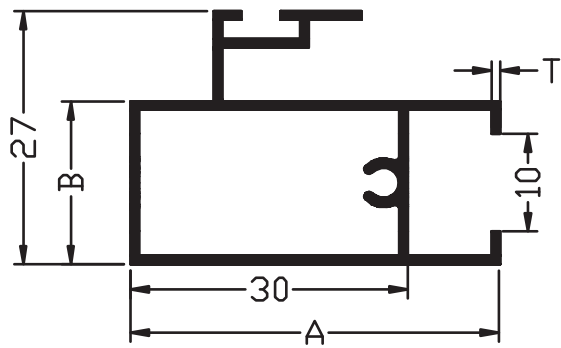

SEC. NO.	C/L	A	B	T	WEIGHT
25	12	40.00	18.00	0.70	1.100-1.200
26	12	40.00	18.00	1.79	1.200-1.400
27	12	40.00	18.00	1.11	1.550-1.700
29	12	40.00	18.00	1.30	1.700-1.850
29	12	40.00	18.00	1.50	2.000-2.200

3/4" TOP BOTTOM

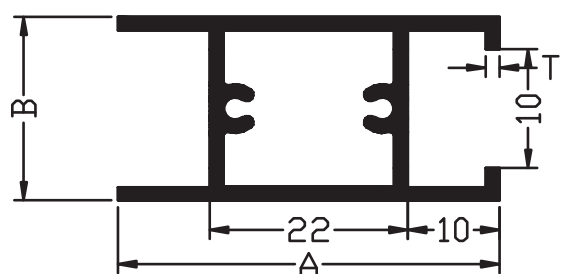

SEC. NO.	C/L	A	B	T	WEIGHT
30	12	40.00	18.00	0.73	1.000-1.200
31	12	40.00	18.00	0.93	1.200-1.400
32	12	40.00	18.00	1.12	1.400-1.600
33	12	40.00	18.00	1.30	1.600-1.750
34	12	40.00	18.00	1.50	1.800-2.000

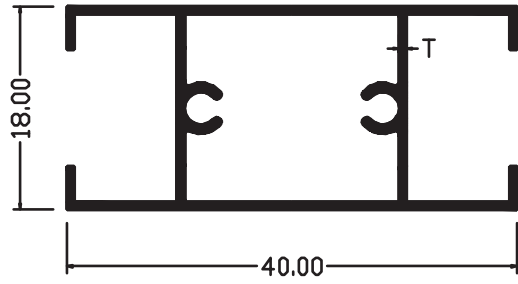

SEC. NO.	C/L	WEIGHT
35	12	0.380

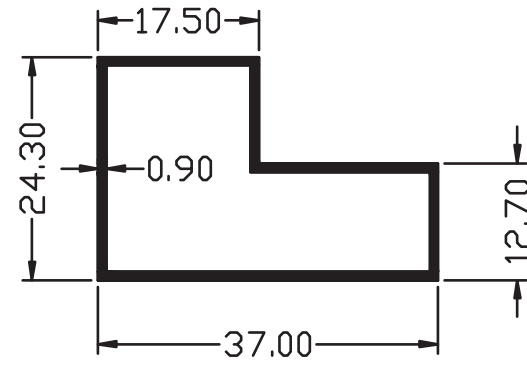

SEC. NO.	C/L	T	WEIGHT
36	12	1.10	1.200
37	12	1.20	1.700

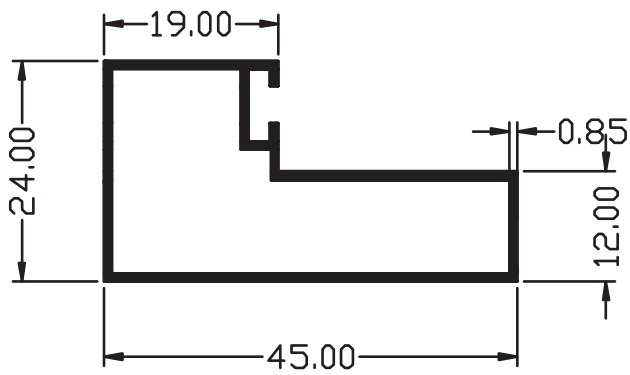

SEC. NO.	C/L	T	WEIGHT
38	12	1.10	1.550
39	12	1.20	1.700

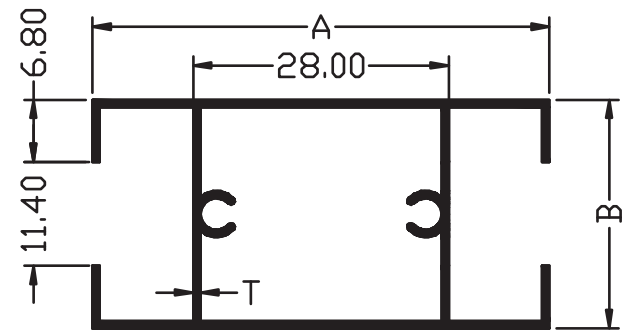

SEC. NO.	C/L	A	B	T	WEIGHT
40	12	50.00	25.00	0.80	1.950
41	12	50.00	25.00	0.80	2.175

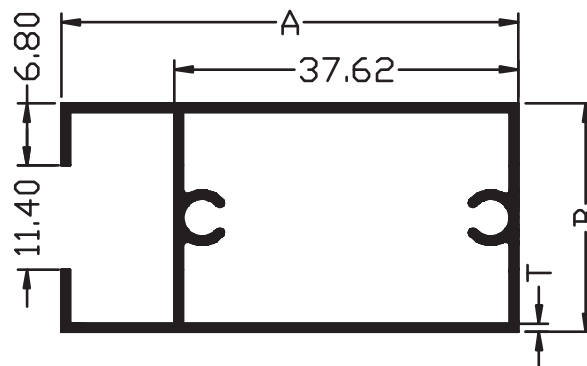

SEC. NO.	C/L	A	B	T	WEIGHT
42	12	50.00	25.00	1.10	1.900
43	12	50.00	25.00	1.20	2.050

SINGLE PARTITION

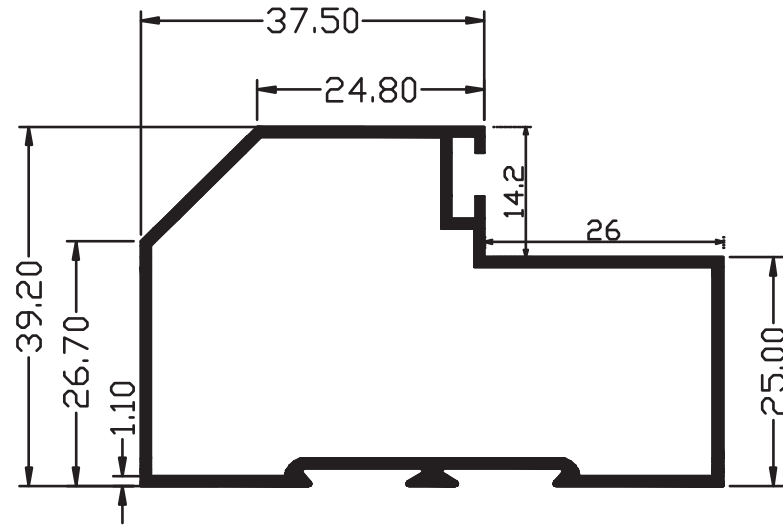

SEC. NO.	C/L	A	B	T	WEIGHT
44	12	64.00	39.50	1.10	2.300
45	12	64.00	39.50	1.20	2.500

DOUBLE PARTITION

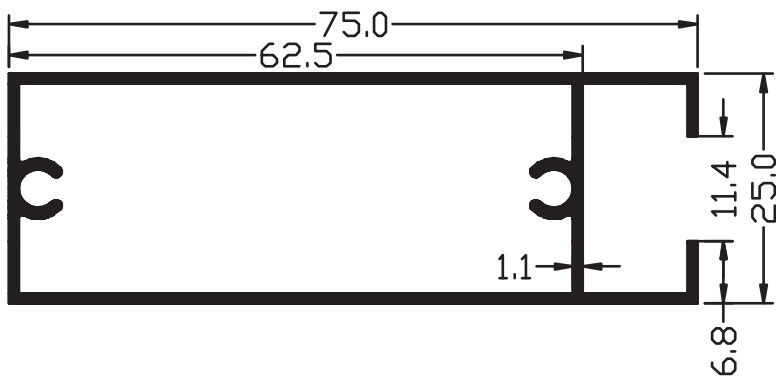

SEC. NO.	C/L	T	WEIGHT
46	12	1.10	2.200
47	12	1.20	2.400

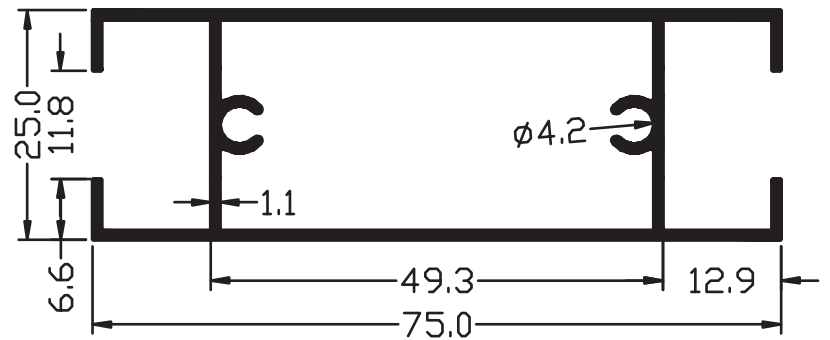

SEC. NO.	C/L	T	WEIGHT
48	12	1.10	2.200
49	12	1.20	2.400

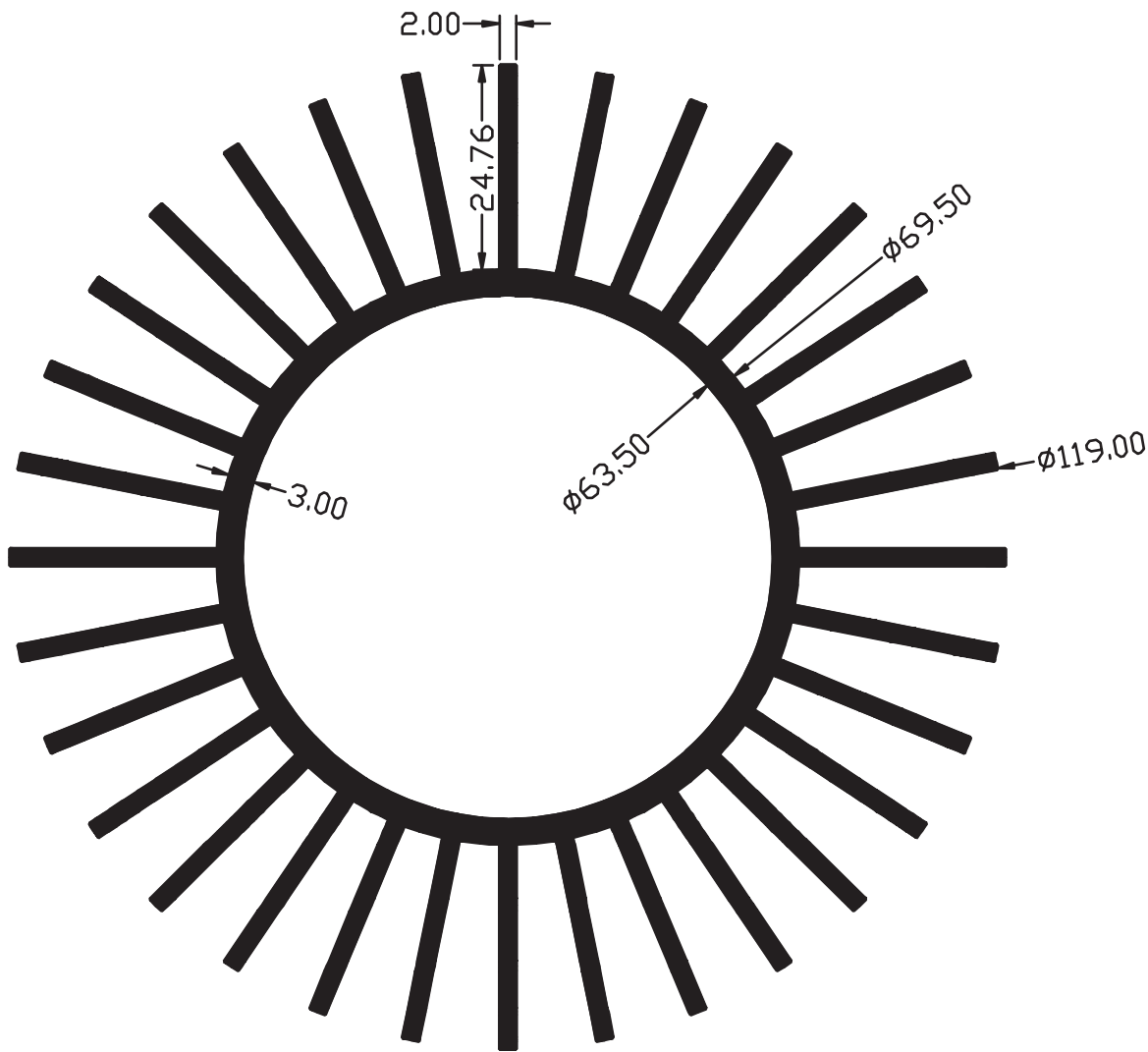

SEC. NO.	C/L	A	B	T	WEIGHT
50	12	119	63.50	3.00	21.666

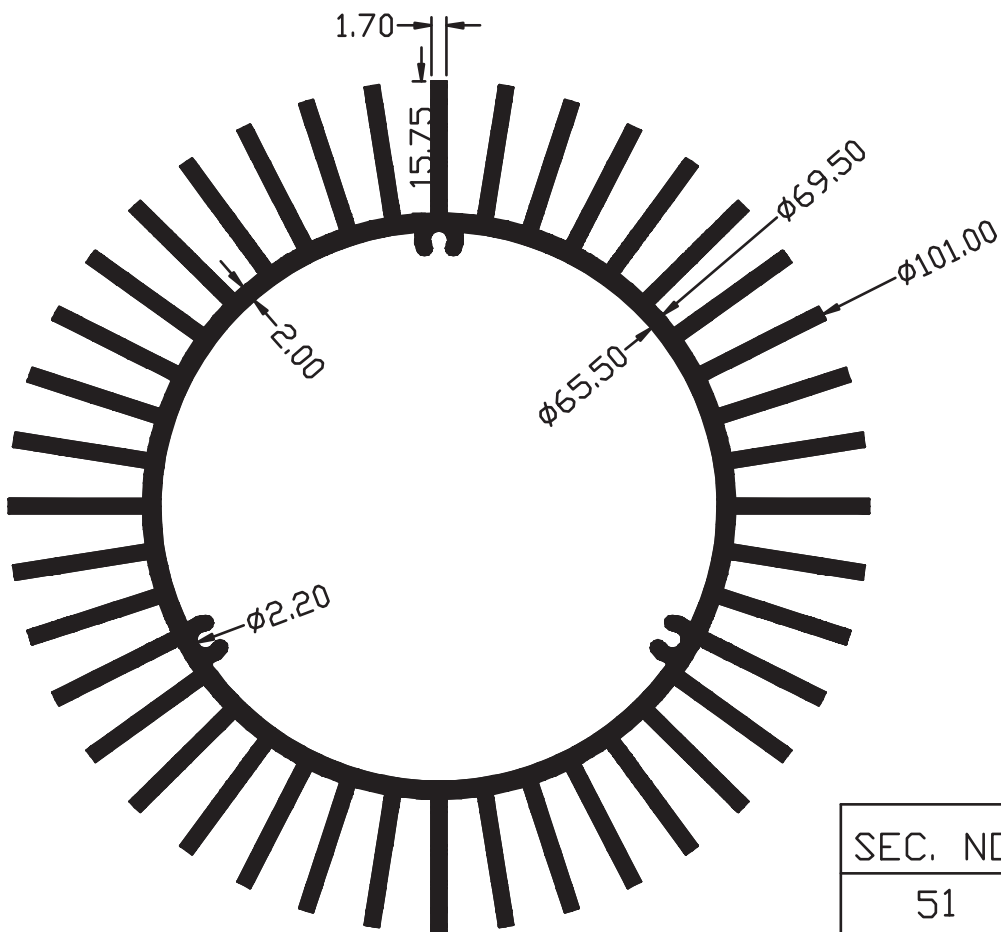

SEC. NO.	C/L	A	B	T	WEIGHT
51	12	101.0	65.50	2.00	14.941

SINGLE PARTITION

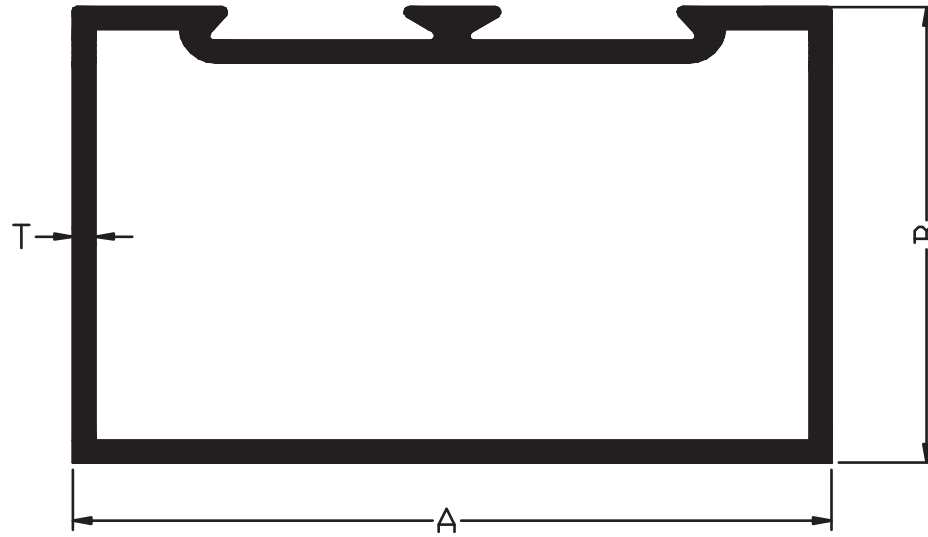

SEC. NO.	C/L	A	B	T	WEIGHT
52	12	63.00	38.00	1.10	2.350-2.550
53	12	63.00	38.00	1.50	3.200-3.500
54	12	63.00	38.00	2.00	4.250-4.550

DOUBLE PARTITION

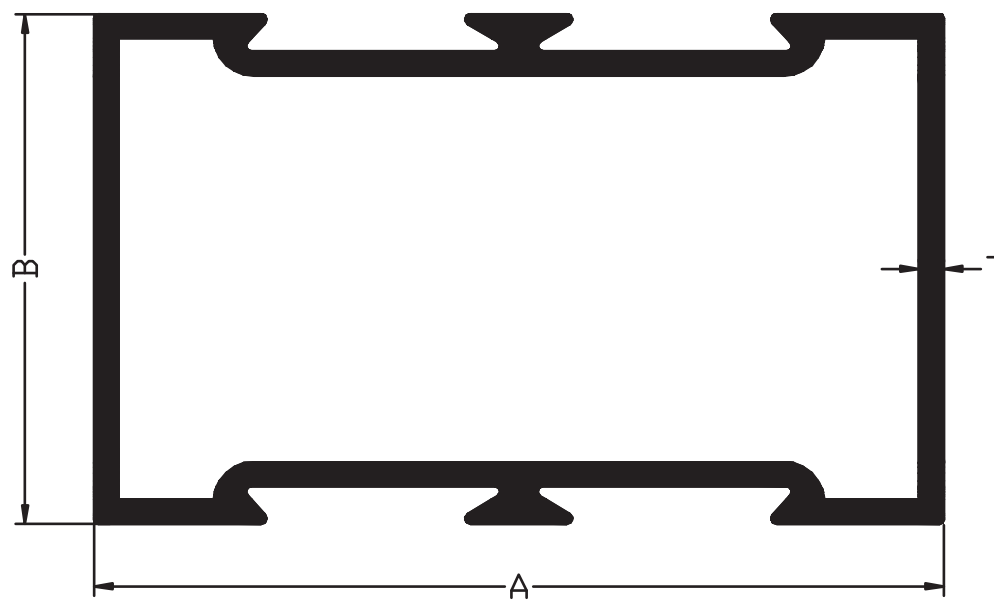

SEC. NO.	C/L	A	B	T	WEIGHT
55	12	63.00	38.00	1.10	2.600-2.800
56	12	63.00	38.00	1.50	3.500-3.700
57	12	63.00	38.00	2.00	4.600-4.800

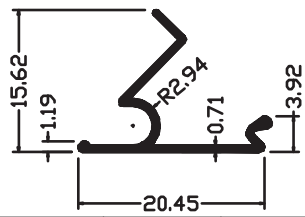

SEC. NO.	C/L	WEIGHT
58	12	0.320

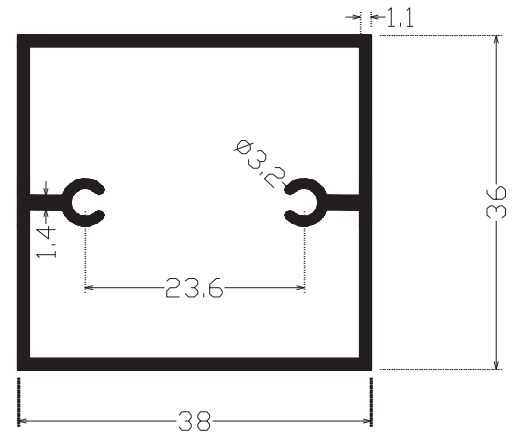

SEC. NO.	C/L	WEIGHT
59	12	1.800

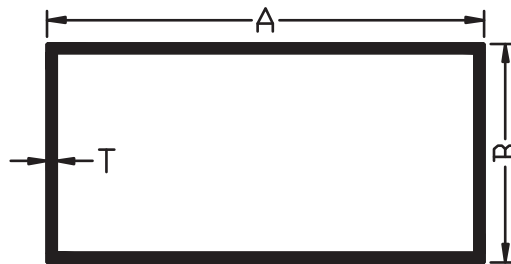

SEC. NO.	C/L	A	B	T	WEIGHT
60	12	48	24	0.75	1.000

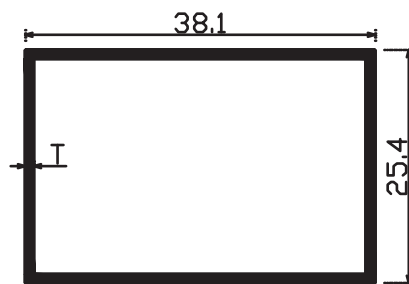

SEC. NO.	C/L	A	B	T	WEIGHT
61	12	38.1	25.4	1.00	1.100

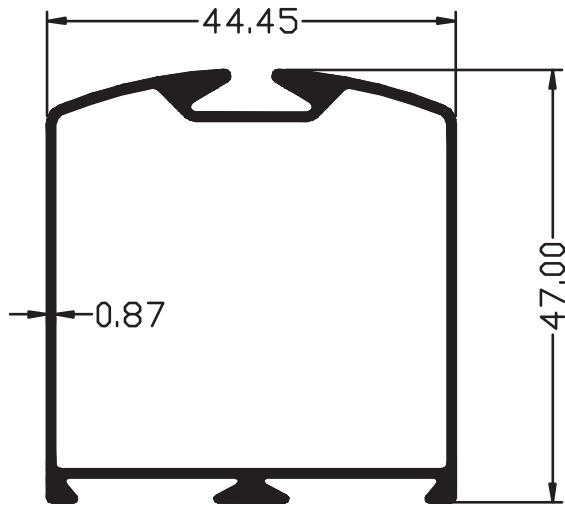

SEC. NO.	C/L	WEIGHT
62	12	2.200-2.400

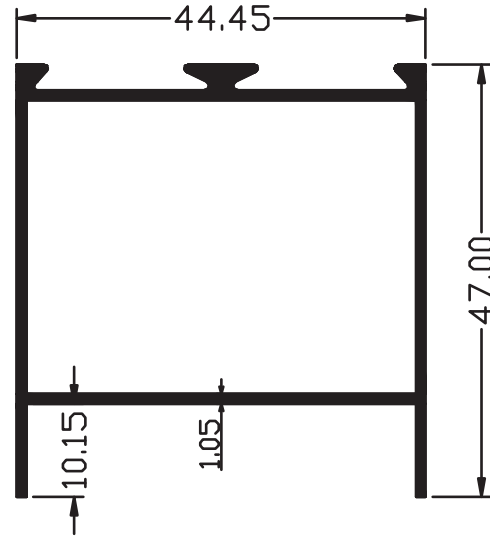

SEC. NO.	C/L	WEIGHT
63	12	2.200-2.400

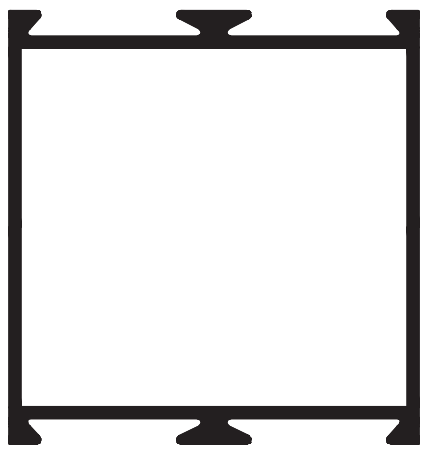

SEC. NO.	C/L	WEIGHT
64	12	2.200

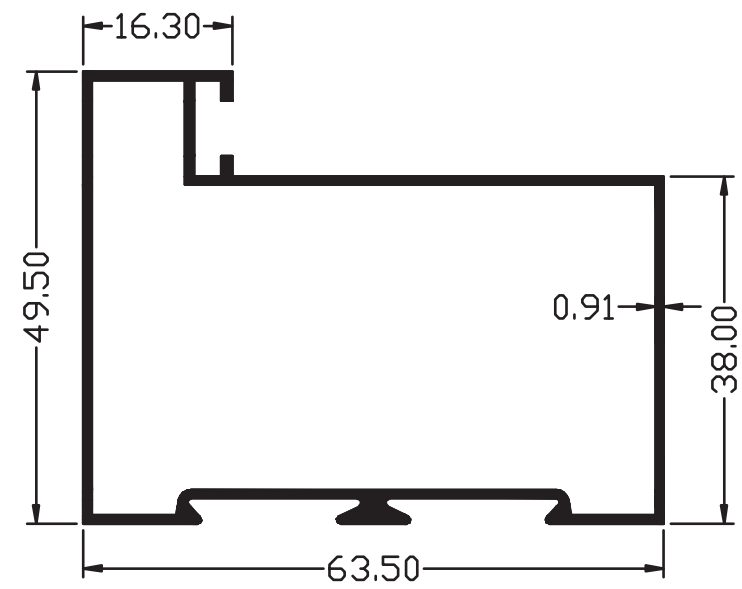

SEC. NO.	C/L	T	WEIGHT
65	12	1.10	2.300

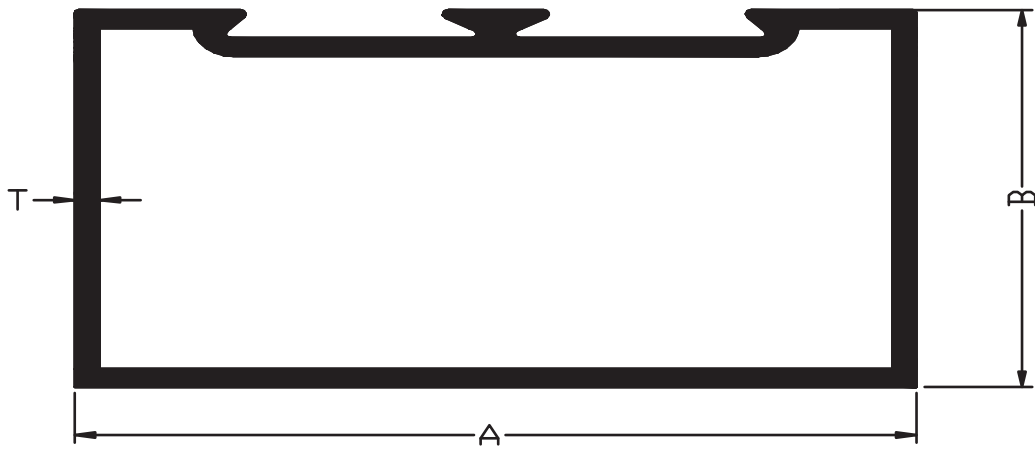

SEC. NO.	C/L	A	B	T	WEIGHT
66	12	101.6	44.45	1.19	3.800-3.900

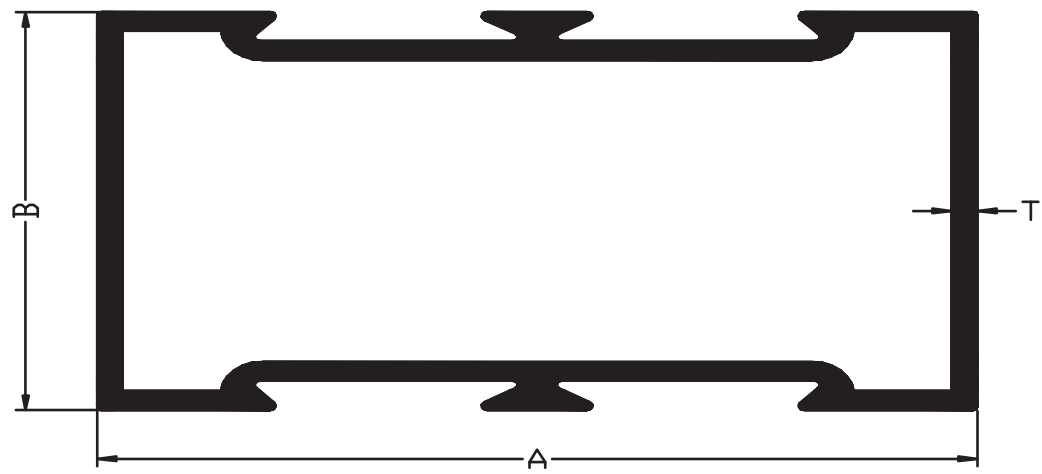

SEC. NO.	C/L	A	B	T	WEIGHT
67	12	101.6	44.45	1.19	3.800-3.900

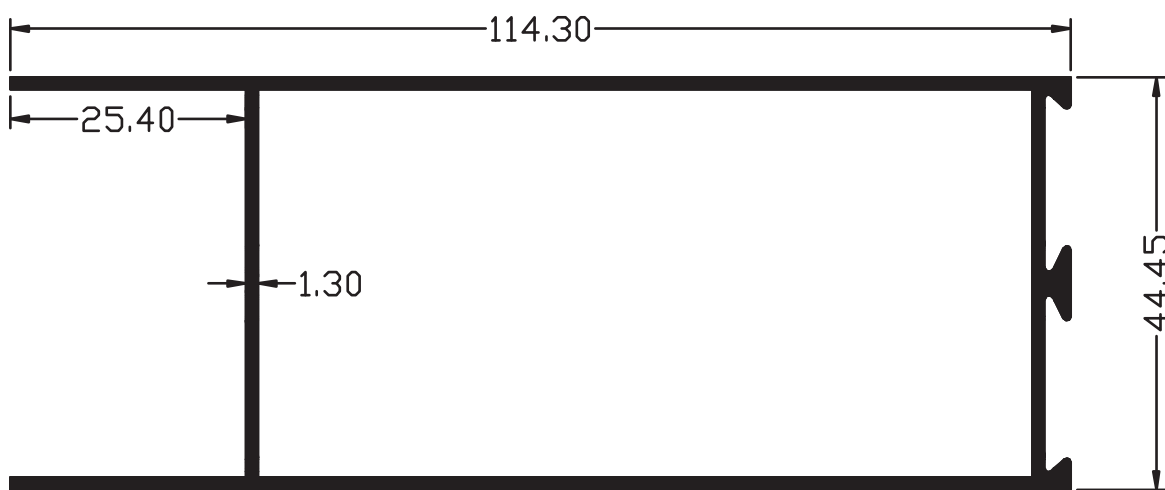

SEC. NO.	C/L	WEIGHT
68	12	4.200-4.400

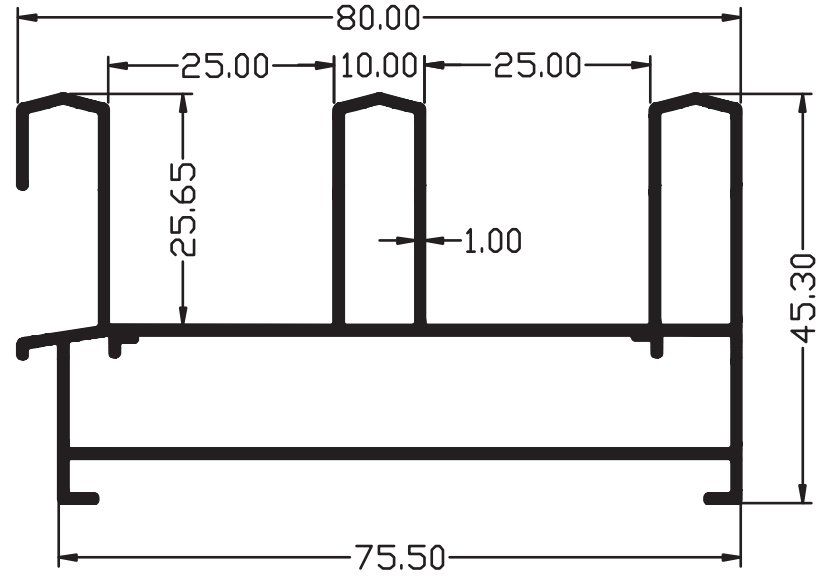
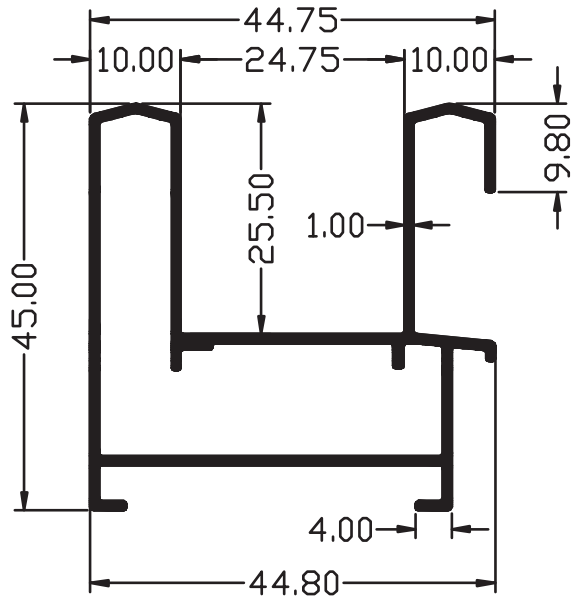

SEC. NO.	C/L	T	WEIGHT
69	12	1.25	2.750
70	12	1.40	3.050

SEC. NO.	C/L	T	WEIGHT
71	12	1.10	3.950
72	12	1.30	4.650

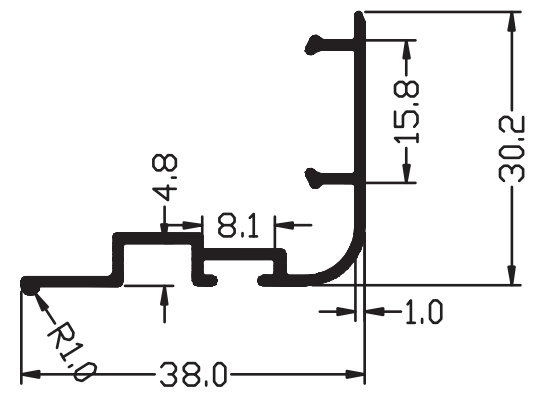
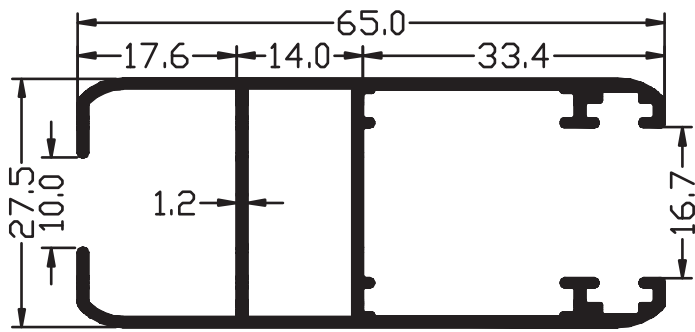

SEC. NO.	C/L	T	WEIGHT
73	12	1.10	2.350
74	12	1.20	2.600

SEC. NO.	C/L	WEIGHT
75	12	0.900-1.100

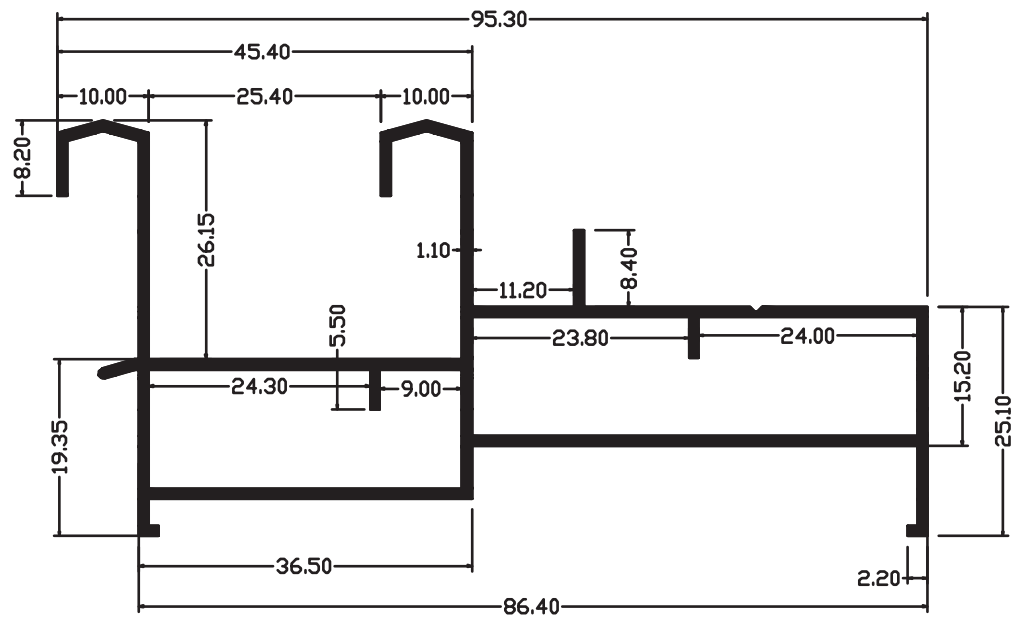

SEC. NO.	C/L	WEIGHT
76	12	3.500

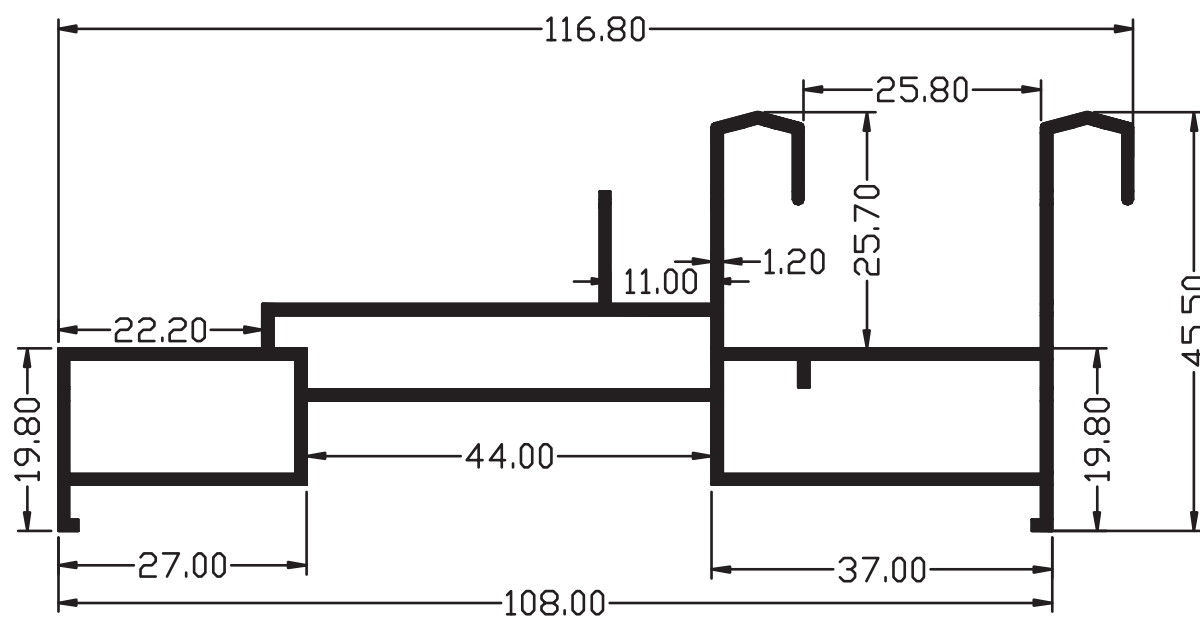

SEC. NO.	T	C/L	WEIGHT
78	1.10	12	4.300
79	1.30	12	4.600

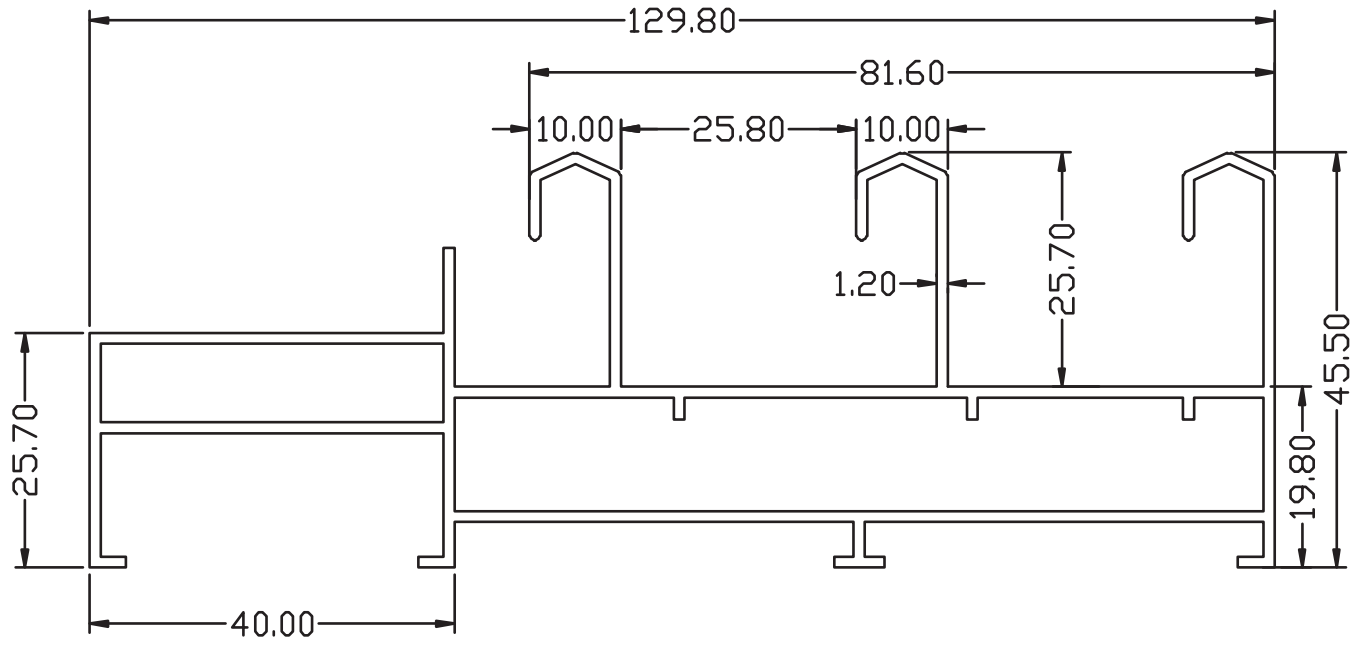

SEC. NO.	C/L	A	B	T	WEIGHT
80	12	127.5	50.00	1.10	5.100
81	12	127.5	50.00	1.25	5.800

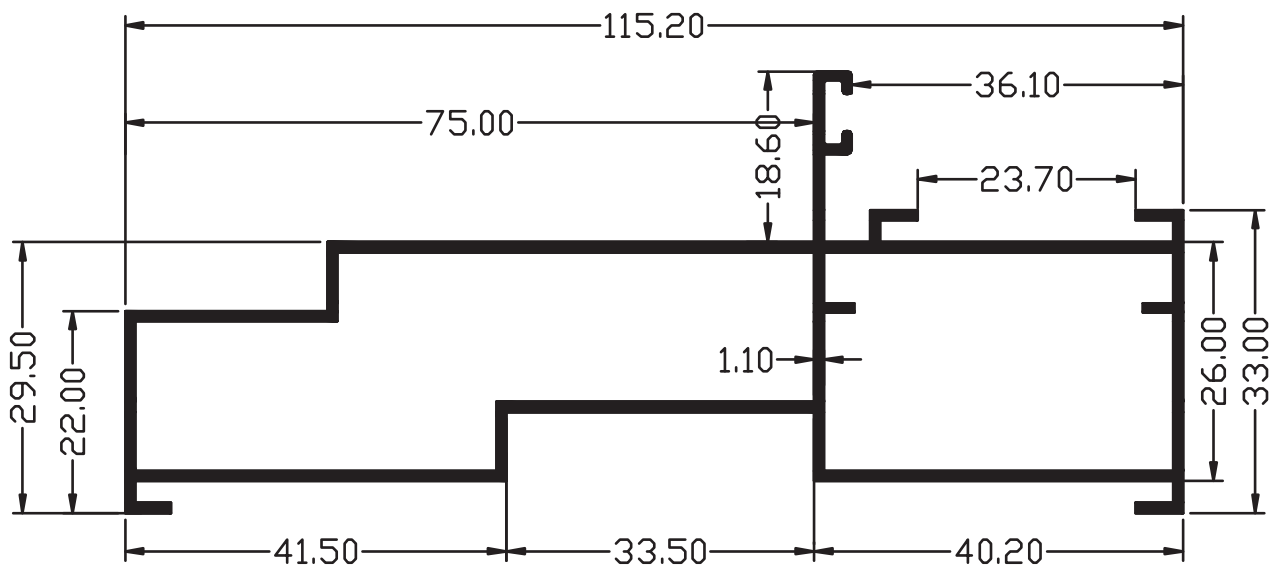

SEC. NO.	T	C/L	WEIGHT
82	1.10	12	4.300
83	1.25	12	3.700

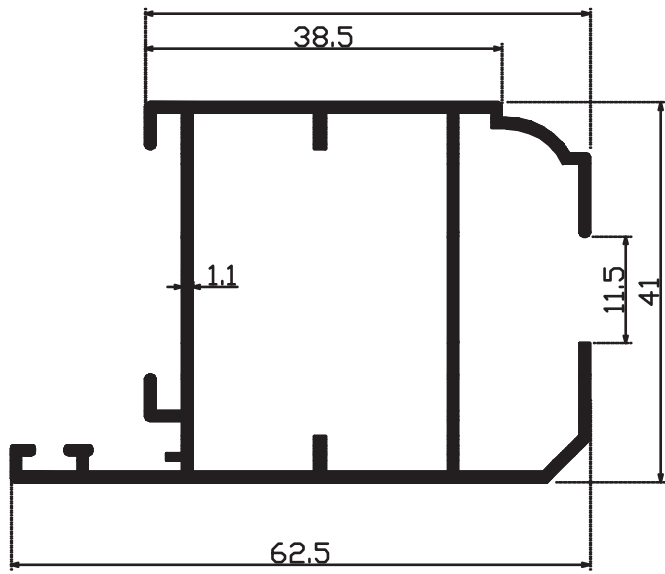

SEC. NO.	C/L	T	WEIGHT
84	12	1.10	2.600
85	12	1.20	2.880

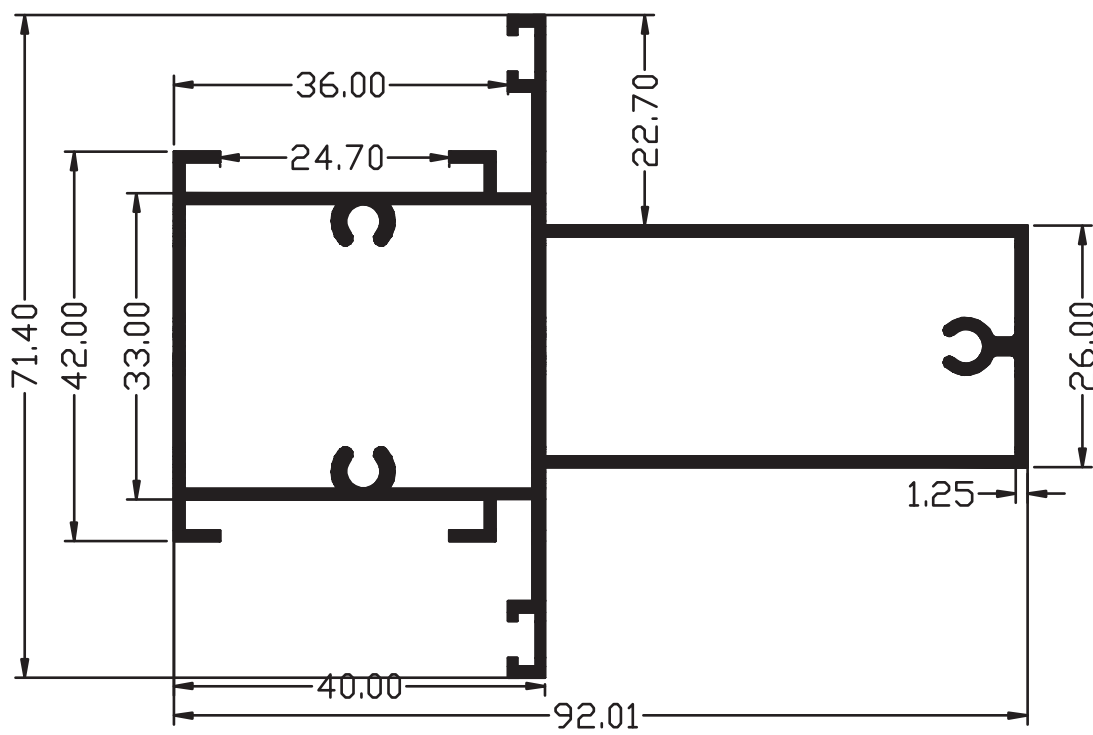

SEC. NO.	C/L	T	WEIGHT
87	12	1.25	4.500
88	12	1.10	3.950

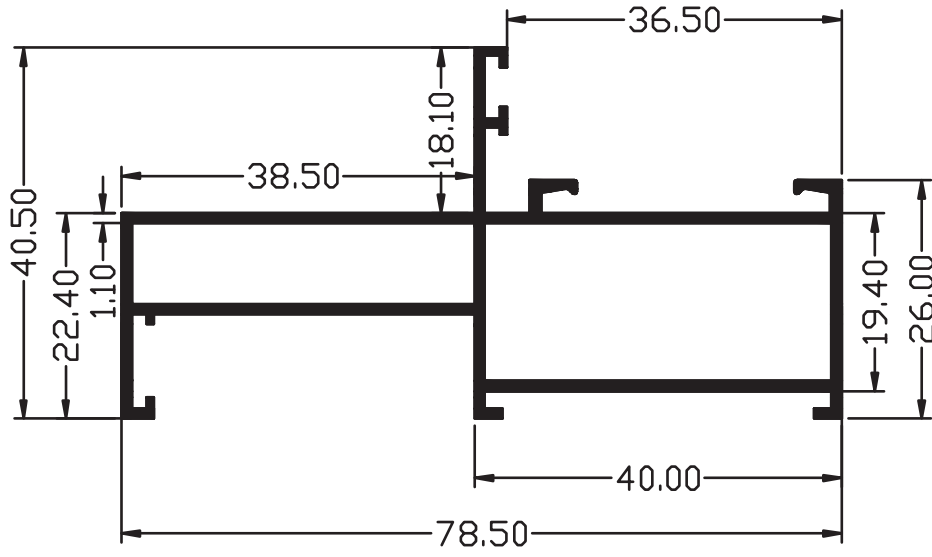

SEC. NO.	C/L	A	B	T	WEIGHT
89	12	78.50	40.50	1.10	2.870
90	12	78.50	40.50	1.20	3.130

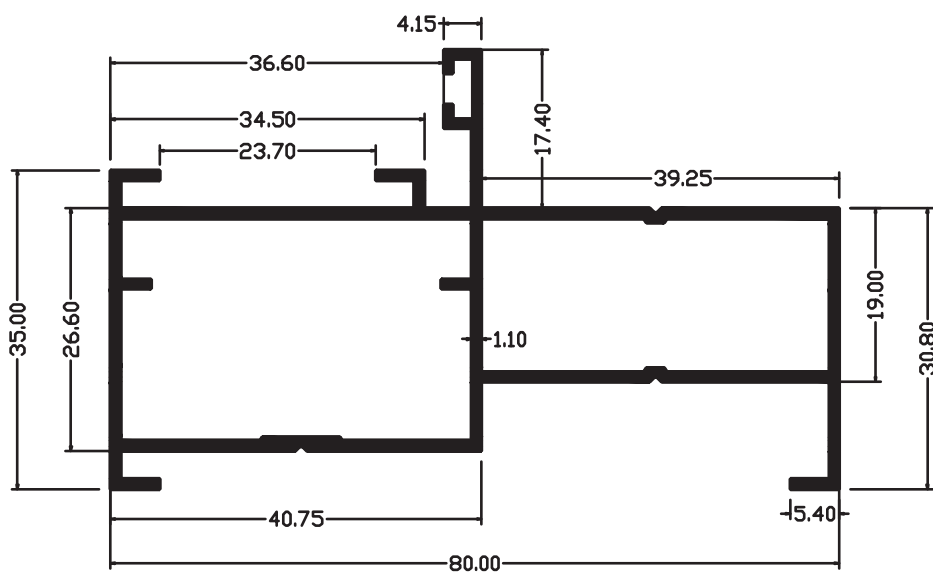

SEC. NO.	C/L	WEIGHT
91	12	3.300

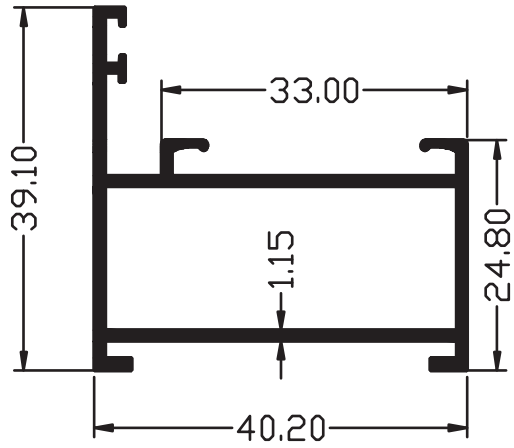

SEC. NO.	C/L	WEIGHT
92	12	1.800-2.000

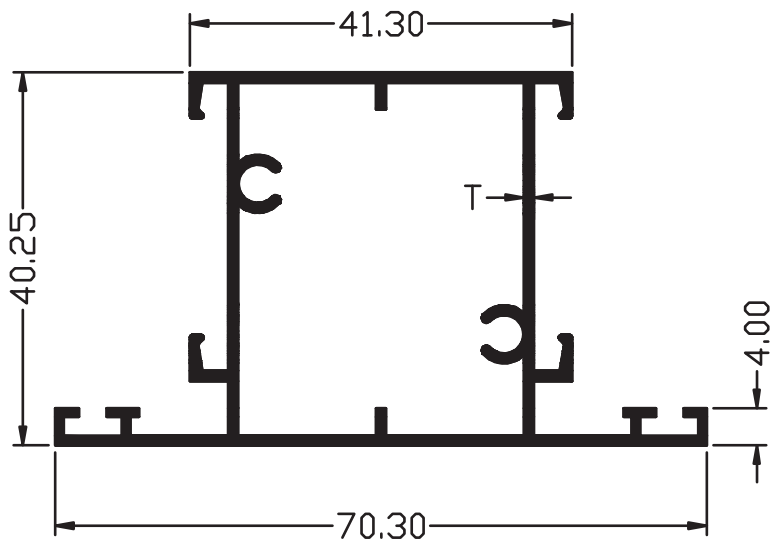

SEC. NO.	C/L	T	WEIGHT
93	12	1.10	2.700
94	12	1.20	2.945

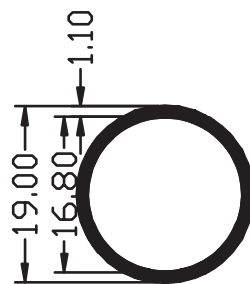

SEC. NO.	C/L	T	WEIGHT
95	12	1.10	0.600

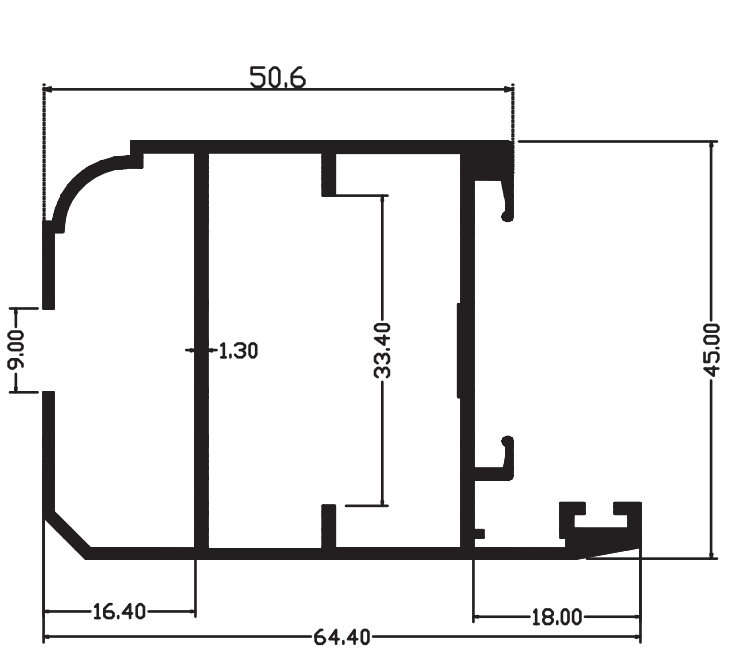

SEC. NO.	C/L	WEIGHT
96	12	3.250

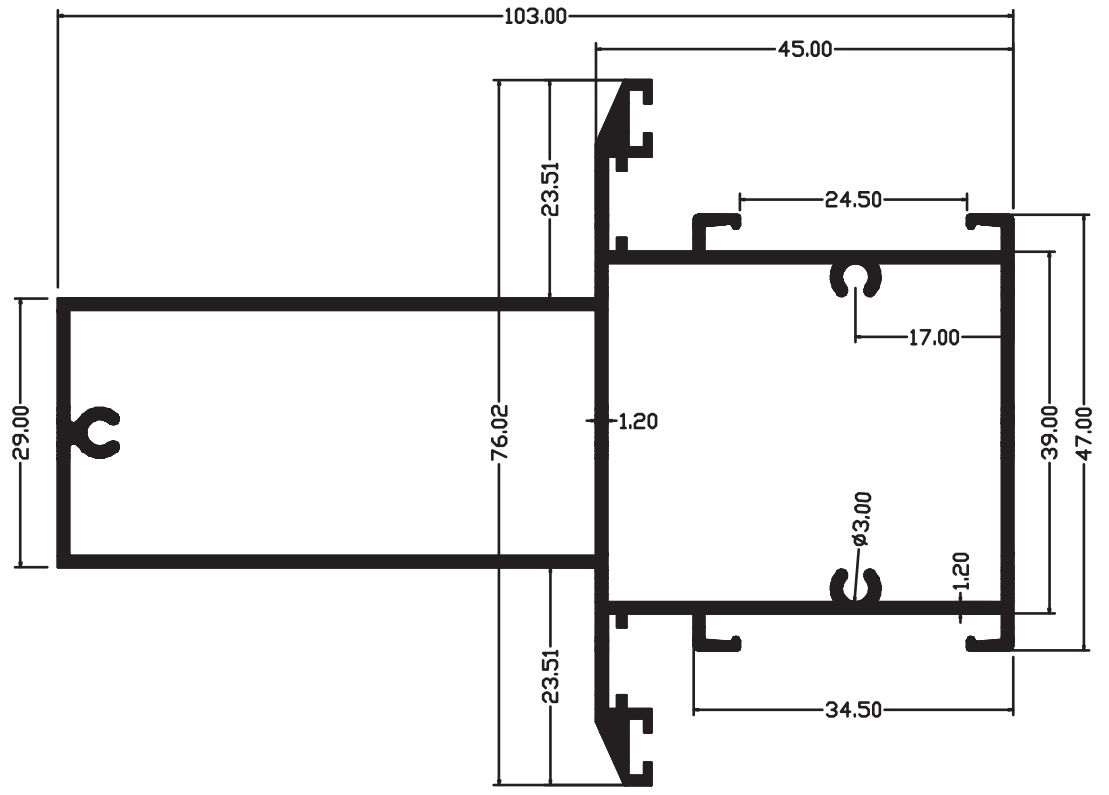

SEC. NO.	C/L	WEIGHT
97	12	5.090

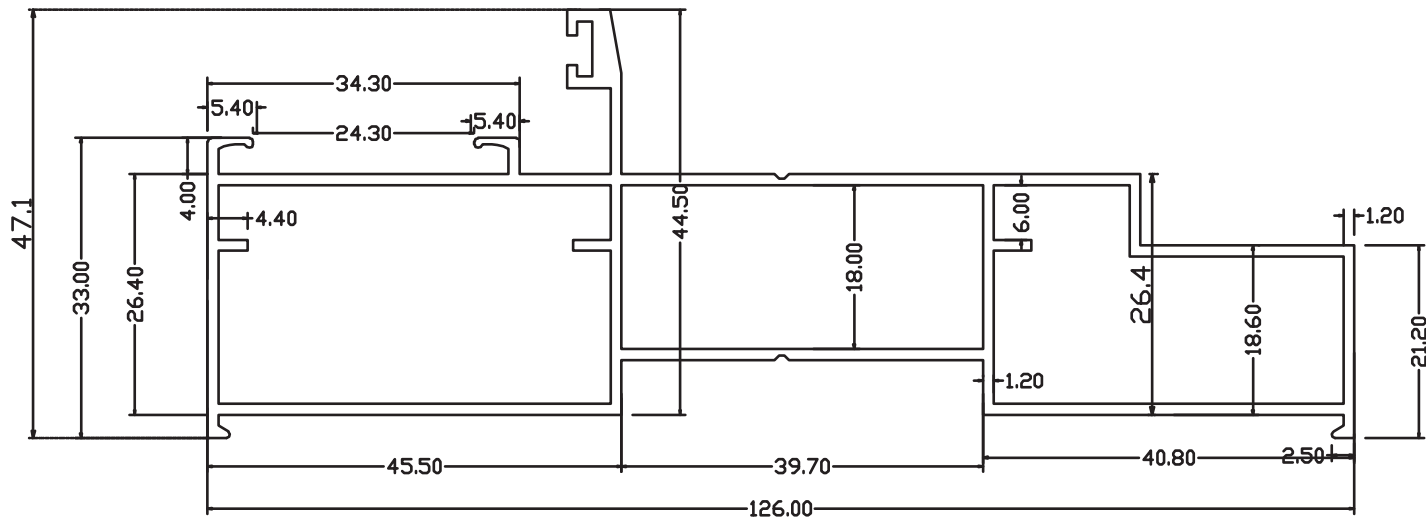

SEC. NO.	C/L	WEIGHT
98	12	4.890

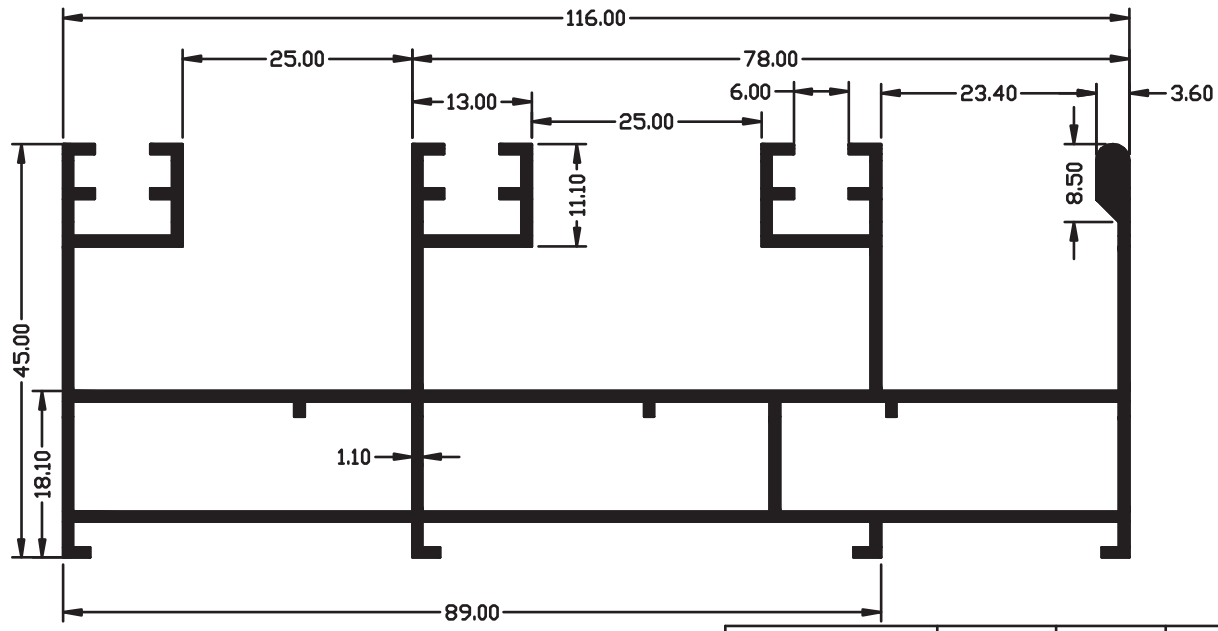

SEC. NO.	C/L	T	WEIGHT
99	12	1.10	3.950
100	12	1.20	4.650

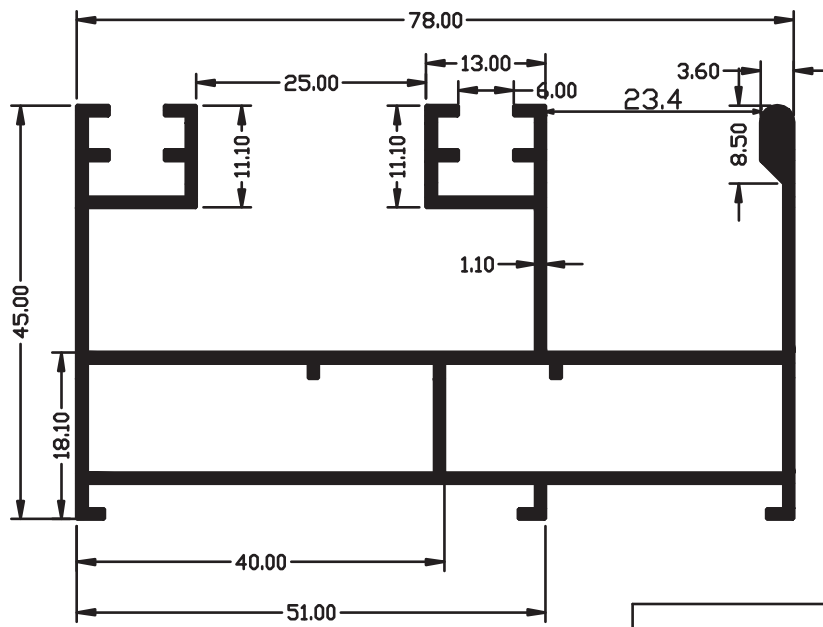

SEC. NO.	C/L	T	WEIGHT
101	12	1.25	4.500
102	12	1.10	4.000

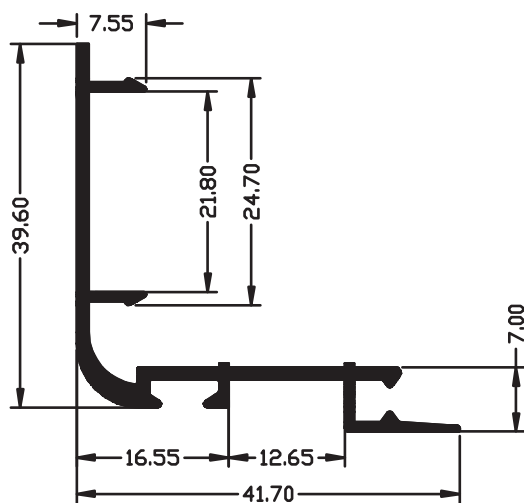

SEC. NO.	C/L	WEIGHT
103	12	1.300-1.500

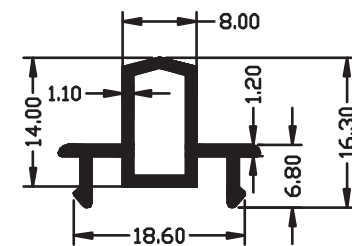

SEC. NO.	C/L	WEIGHT
104	12	0.700-0.900

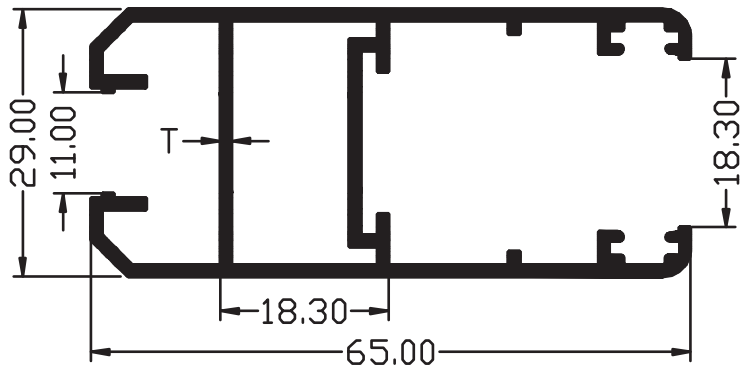

SEC. NO.	C/L	T	WEIGHT
105	12	1.10	2.550
106	12	1.25	2.900

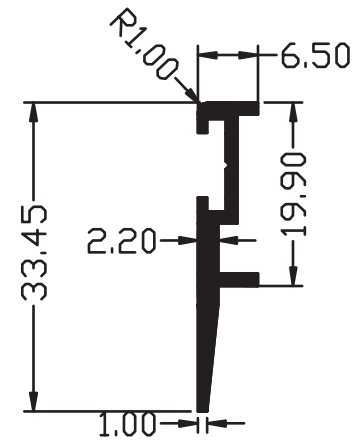
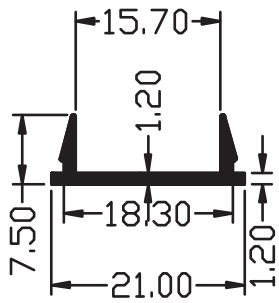

SEC. NO.	C/L	WEIGHT
107	12	0.380

SEC. NO.	C/L	WEIGHT
108	12	0.740

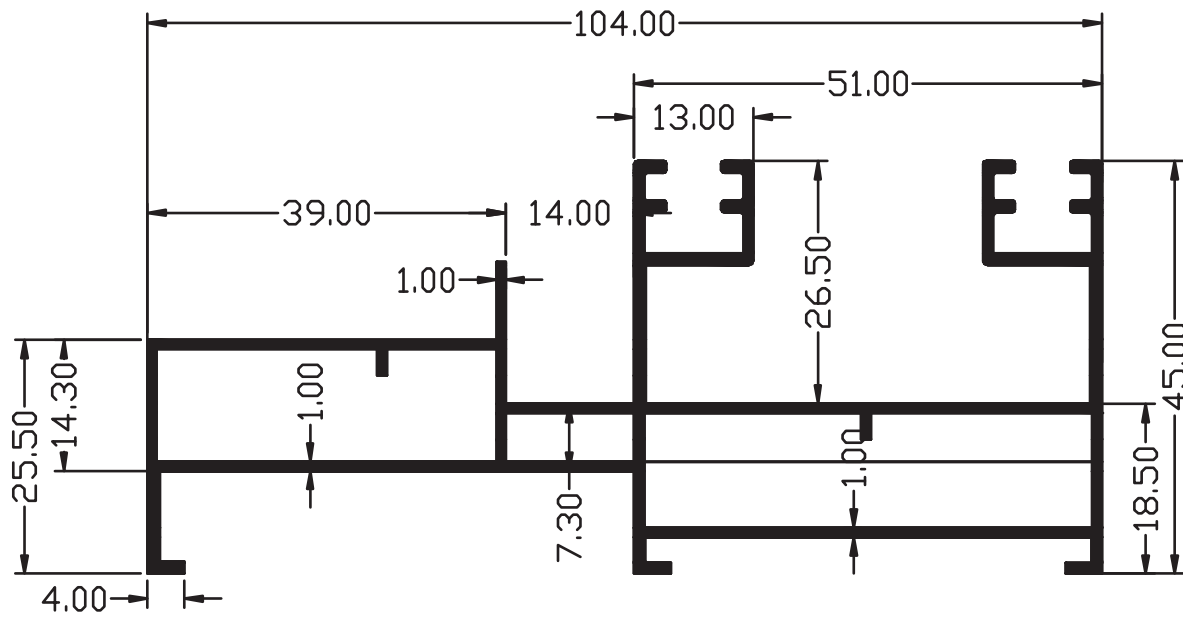

SEC. NO.	C/L	A	B	T	WEIGHT
109	12	130.0	45.00	1.20	5.465

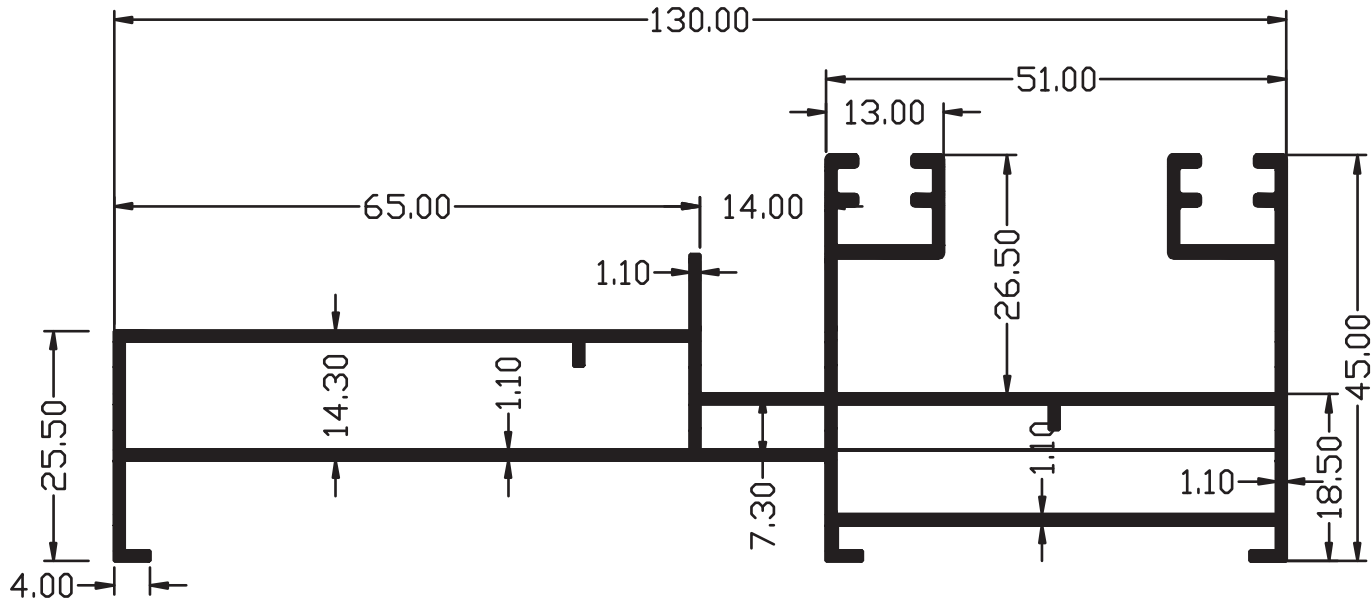

SEC. NO.	C/L	A	B	T	WEIGHT
110	12	130.0	45.00	1.10	5.120

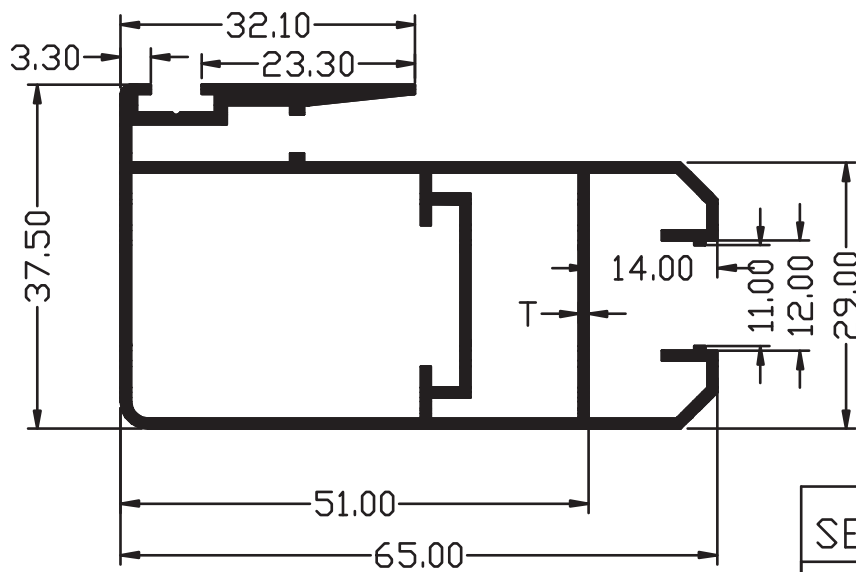

SEC. NO.	C/L	T	WEIGHT
111	12	1.10	3.340
112	12	1.30	3.800

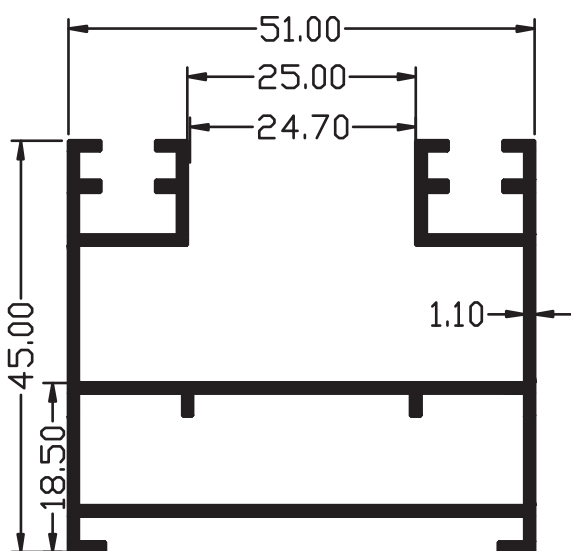

SEC. NO.	C/L	T	WEIGHT
113	12	1.10	2.840
114	12	1.25	3.220

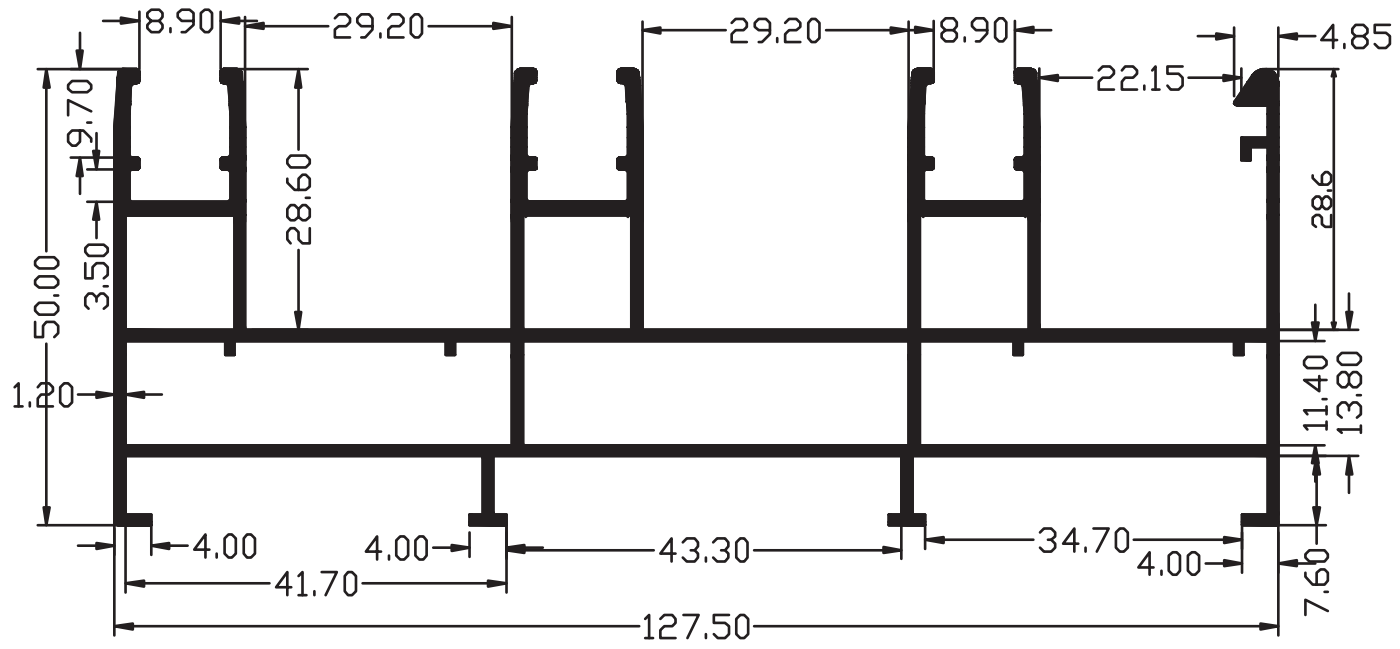

SEC. NO.	C/L	A	B	T	WEIGHT
115	12	127.5	50.00	1.50	9.400
116	12	127.5	50.00	1.25	7.850

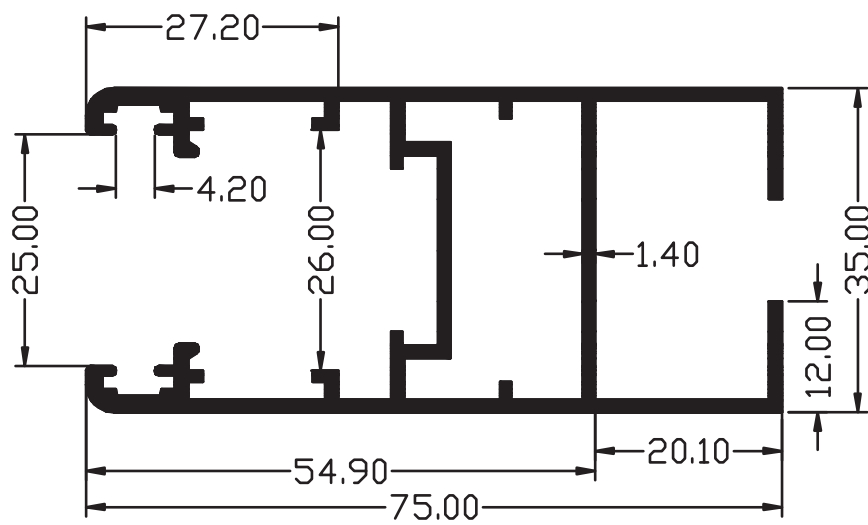

SEC. NO.	C/L	T	WEIGHT
117	12	1.25	3.550
118	12	1.40	4.000

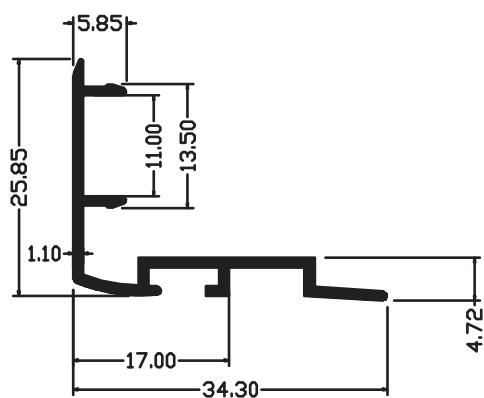

SEC. NO.	C/L	WEIGHT
120	16	1.100

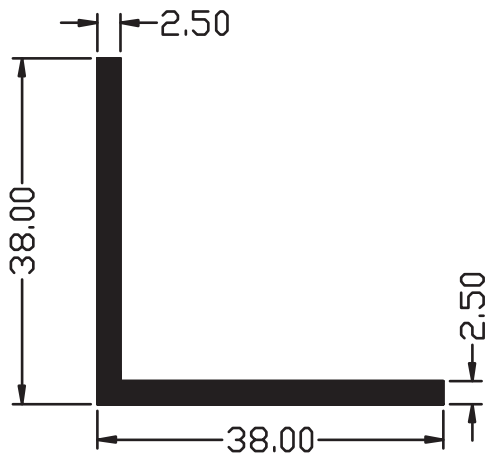

SEC. NO.	C/L	WEIGHT
121	12	1.800

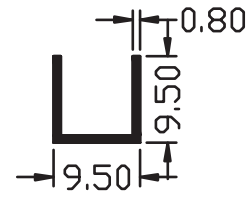

SEC. NO.	C/L	WEIGHT
122	12	0.210

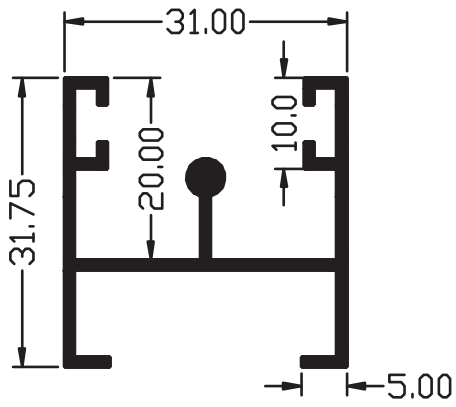

SEC. NO.	C/L	WEIGHT
123	12	1.500

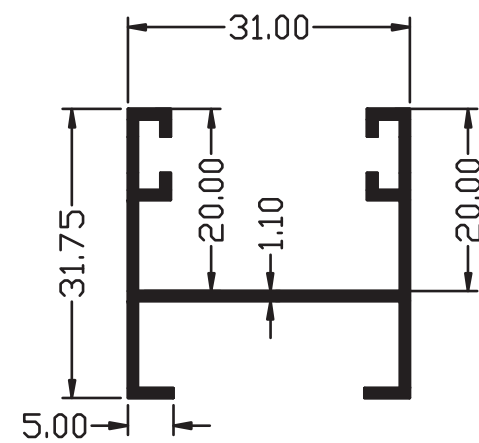

SEC. NO.	C/L	WEIGHT
124	12	1.300

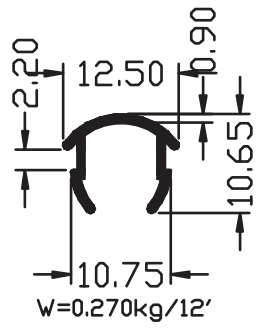

SEC. NO.	C/L	WEIGHT
125	12	0.270-0.470

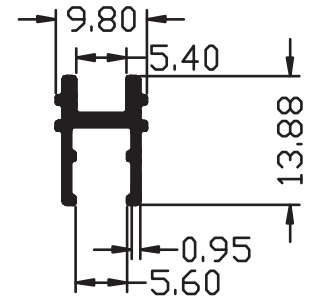

SEC. NO.	C/L	WEIGHT
126	12	0.440-0.640

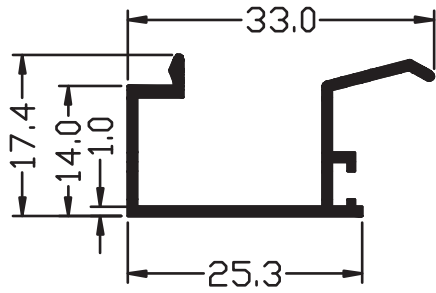

SEC. NO.	C/L	WEIGHT
127	12	0.750-0.950

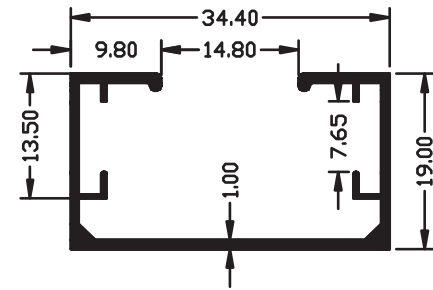

SEC. NO.	C/L	WEIGHT
128	12	0.900-1.100

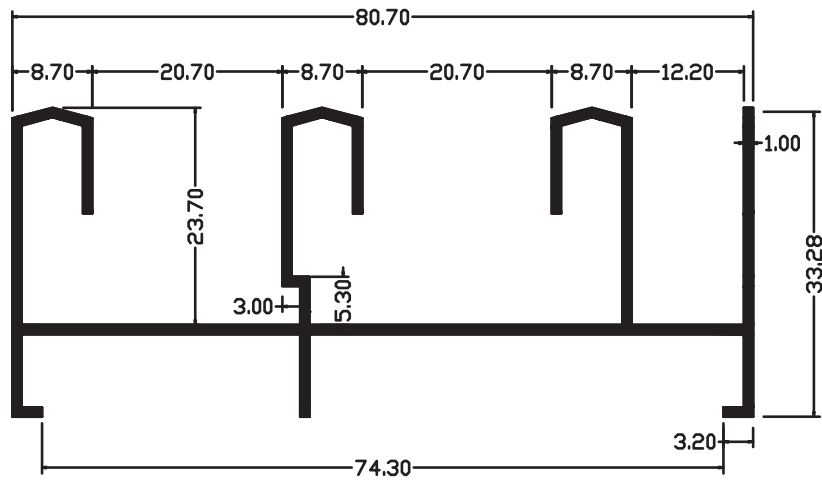

SEC. NO.	C/L	WEIGHT
129	16	3.300

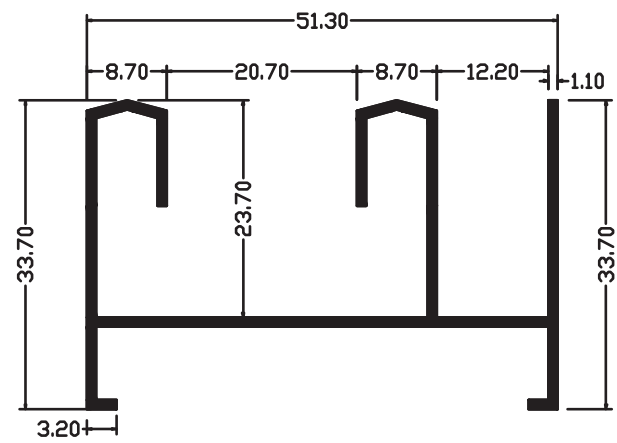

SEC. NO.	C/L	WEIGHT
130	16	2.600

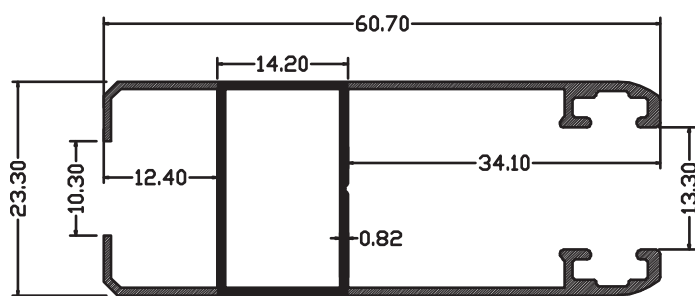

SEC. NO.	C/L	WEIGHT
131	16	2.300

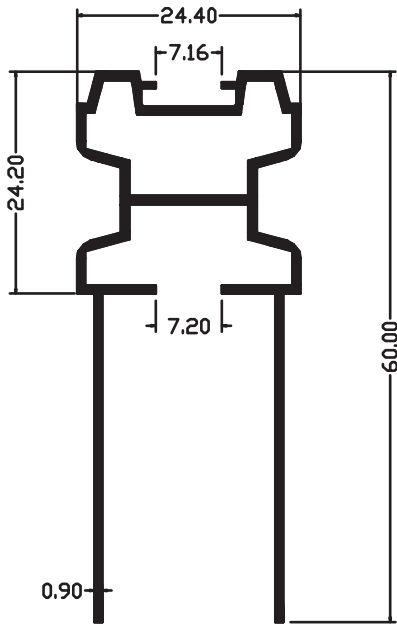

SEC. NO.	C/L	WEIGHT
134	12	1.650

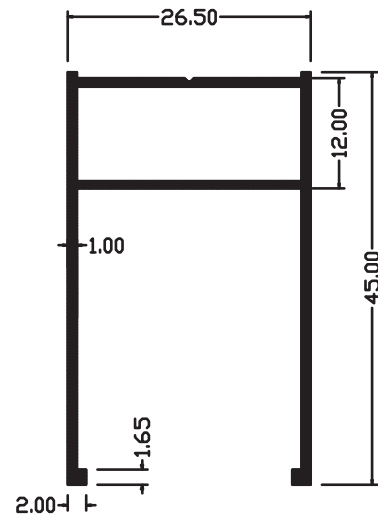

SEC. NO.	C/L	WEIGHT
137	12	1.300

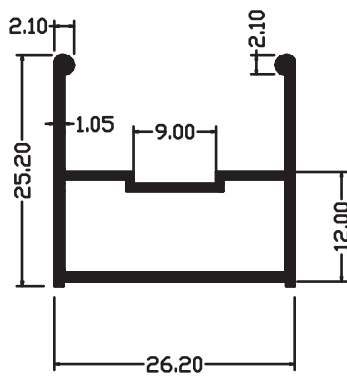

SEC. NO.	C/L	WEIGHT
135	12	1.000

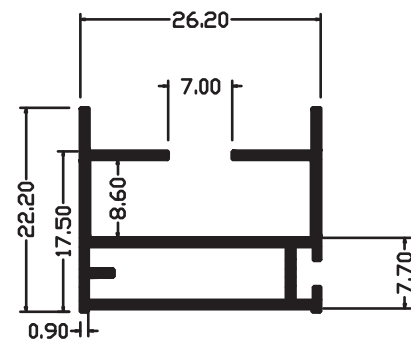

SEC. NO.	C/L	WEIGHT
138	12	1.000

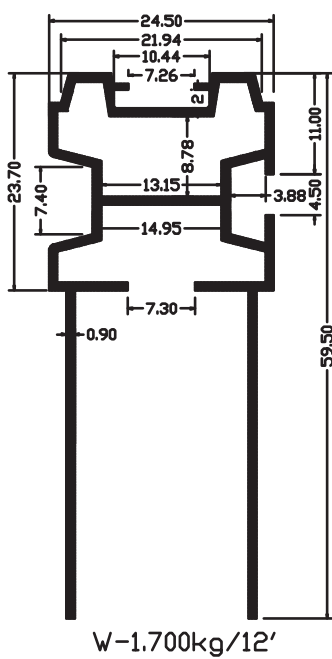

SEC. NO.	C/L	WEIGHT
136	12	1.700

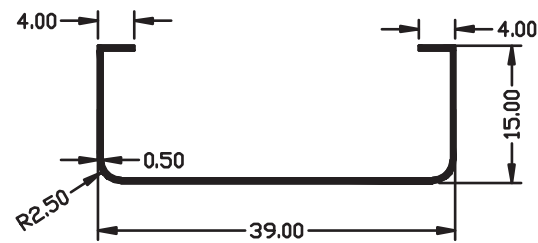

SEC. NO.	C/L	WEIGHT
139	12	0.350

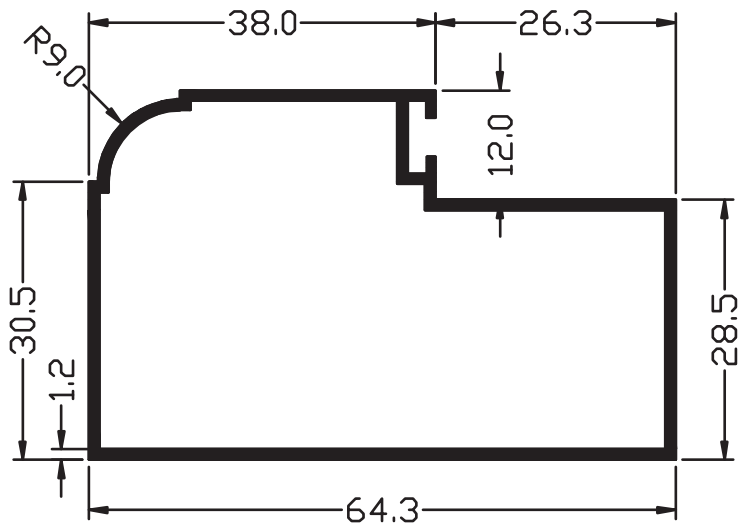

SEC. NO.	C/L	WEIGHT
140	12	2.300

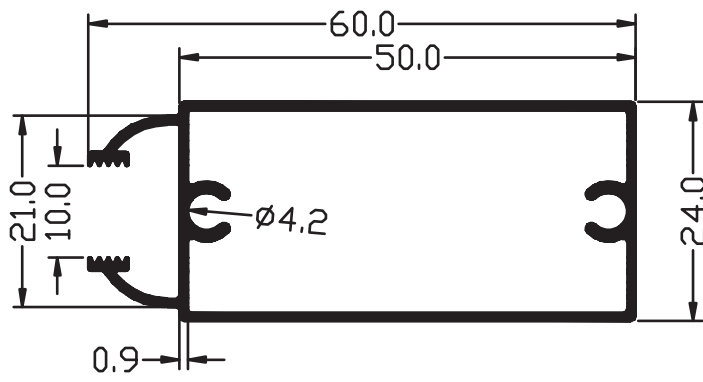

SEC. NO.	C/L	WEIGHT
141	12	1.750

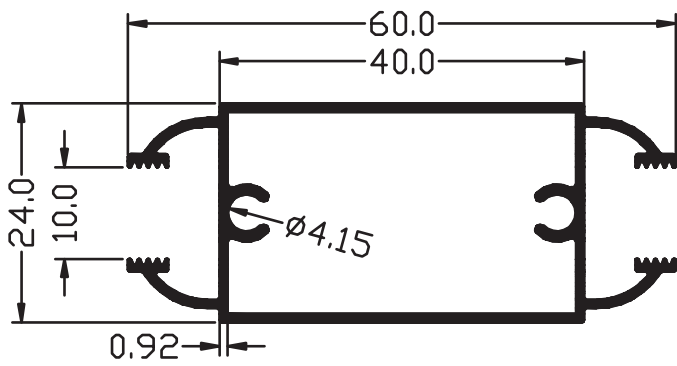

SEC. NO.	C/L	WEIGHT
142	12	1.850

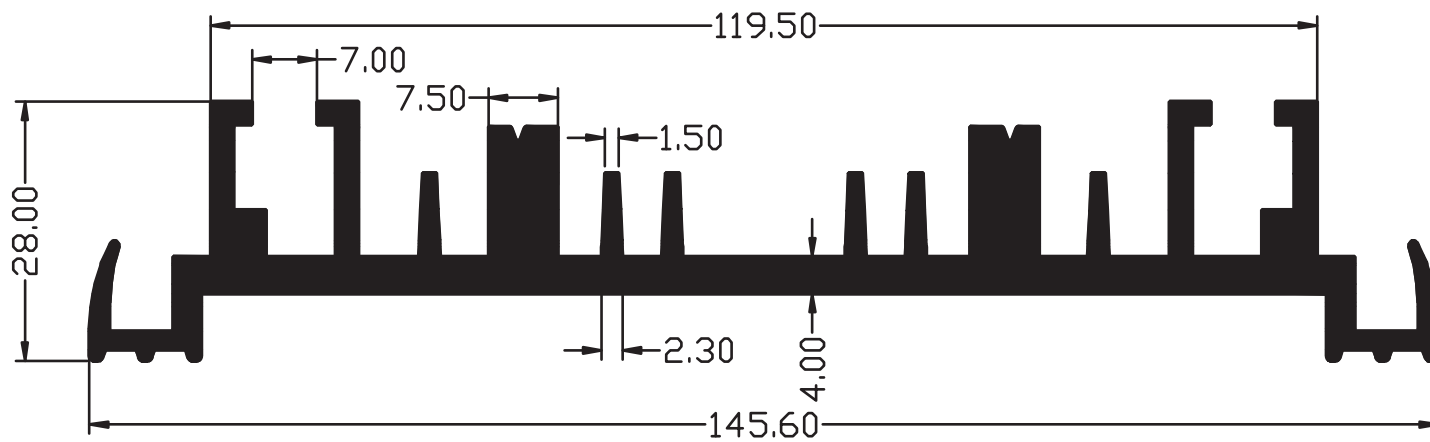

SEC. NO.	C/L	WEIGHT
143	12	11.350